

Алматы (727)345-47-04
Ангарск (3955)60-70-56
Архангельск (8182)63-90-72
Астрахань (8512)99-46-04
Барнаул (3852)73-04-60
Белгород (4722)40-23-64
Благовещенск (4162)22-76-07
Брянск (4832)59-03-52
Владивосток (423)249-28-31
Владикавказ (8672)28-90-48
Владимир (4922)49-43-18
Волгоград (844)278-03-48
Вологда (8172)26-41-59
Воронеж (473)204-51-73
Екатеринбург (343)384-55-89

Иваново (4932)77-34-06
Ижевск (3412)26-03-58
Иркутск (395)279-98-46
Казань (843)206-01-48
Калининград (4012)72-03-81
Калуга (4842)92-23-67
Кемерово (3842)65-04-62
Киров (8332)68-02-04
Коломна (4966)23-41-49
Кострома (4942)77-07-48
Краснодар (861)203-40-90
Красноярск (391)204-63-61
Курск (4712)77-13-04
Курган (3522)50-90-47
Липецк (4742)52-20-81

Магнитогорск (3519)55-03-13
Москва (495)268-04-70
Мурманск (8152)59-64-93
Набережные Челны (8552)20-53-41
Нижний Новгород (831)429-08-12
Новокузнецк (3843)20-46-81
Ноябрьск (3496)41-32-12
Новосибирск (383)227-86-73
Омск (3812)21-46-40
Орел (4862)44-53-42
Оренбург (3532)37-68-04
Пенза (8412)22-31-16
Петрозаводск (8142)55-98-37
Псков (8112)59-10-37
Пермь (342)205-81-47

Ростов-на-Дону (863)308-18-15
Рязань (4912)46-61-64
Самара (846)206-03-16
Санкт-Петербург (812)309-46-40
Саратов (845)249-38-78
Севастополь (8692)22-31-93
Саранск (8342)22-96-24
Симферополь (3652)67-13-56
Смоленск (4812)29-41-54
Сочи (862)225-72-31
Ставрополь (8652)20-65-13
Сургут (3462)77-98-35
Сыктывкар (8212)25-95-17
Тамбов (4752)50-40-97
Тверь (4822)63-31-35

Тольятти (8482)63-91-07
Томск (3822)98-41-53
Тула (4872)33-79-87
Тюмень (3452)66-21-18
Ульяновск (8422)24-23-59
Улан-Удэ (3012)59-97-51
Уфа (347)229-48-12
Хабаровск (4212)92-98-04
Чебоксары (8352)28-53-07
Челябинск (351)202-03-61
Череповец (8202)49-02-64
Чита (3022)38-34-83
Якутск (4112)23-90-97
Ярославль (4852)69-52-93

Россия +7(495)268-04-70

Казахстан +7(727)345-47-04

Беларусь +(375)257-127-884

Узбекистан +998(71)205-18-59

Киргизия +996(312)96-26-47

<https://lanbao.nt-rt.ru/> || ahj@nt-rt.ru

LANBAO

PRODUCT SUMMARY

Sensing the dream

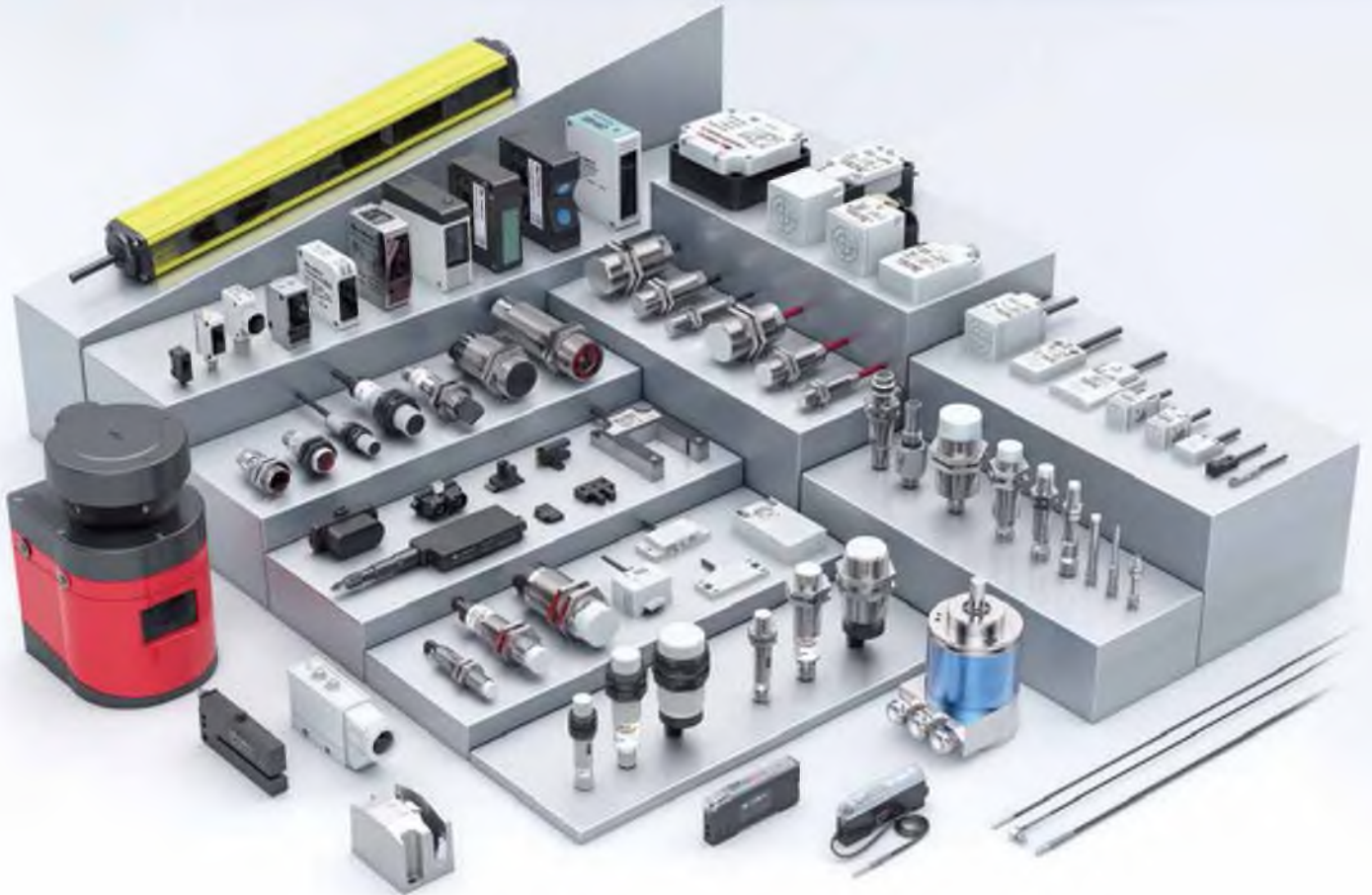

Shanghai Lanbao Sensing Technology Co., Ltd.



Shanghai Lanbao Sensing Technology Co., Ltd.

Established in 1998, Shanghai Lanbao Sensing Technology Co., Ltd. is a supplier of intelligent manufacturing core components and application equipment, national science and technology "Little Giant" enterprise supported by the government, National intellectual property advantage enterprises, Shanghai Enterprise Technology Center, "TOP 100" of Shanghai hard core technology enterprises in 2022, First batch of 20 smart factories in Shanghai in 2020, Director unit of Shanghai industrial technology innovation promotion association. Our products include intelligent inductive sensor, photoelectric sensor and capacitive sensor, which can fully meet the perception needs of discrete industrial customers for positioning, distance and displacement measuring, or speed testing in various applications, such as high temperature, electromagnetic interference, narrow space, or strong light reflection etc.

Lanbao always adheres to the development concept of taking scientific and technological innovation as the first driving force, continues to expand the application of intelligent sensing and measuring technology in the industrial Internet of things, meets the digital and intelligent needs of customers in the upgrading of intelligent manufacturing, helps the localization process of intelligent manufacturing equipment industry, and firmly contributes to the prosperous development of China's sensing industry.



LANBAO SENSOR



With excellent talents, core technology, Lanbao always concentrates on industrial automation field. By introducing global leading management philosophy and systems, congregating design, development, research and production, it is aim of Lanbao that finally to be a leading manufacturer in global industrial automation field. Our series international leading automation manufacturing equipments ensure international technical level and reliable quality, our strict quality management and control process guarantee "zero defect" products.

Total Quality Management

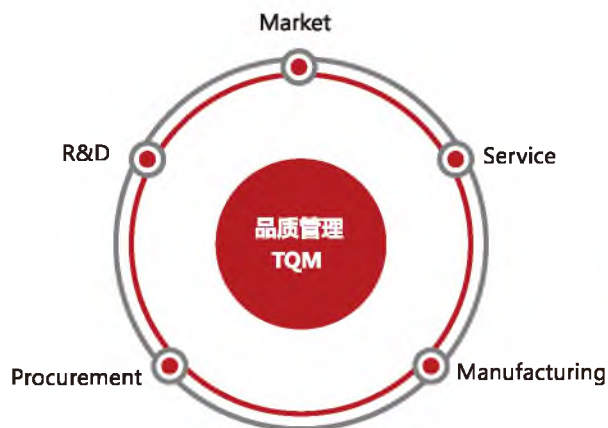

Complete IQC,OQC testing process

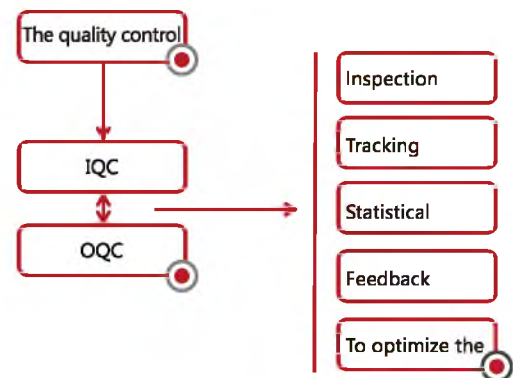

04 Inductive sensors

- 06 Standard function
- 14 Frequency enhanced
- 14 Extended sensing distance
- 17 Analog output
- 18 Extended temperature
- 19 High pressure resistant
- 20 Full metal housing
- 21 Rotation speed monitor
- 22 Gear speed monitoring
- 23 Welding-immune
- 24 Self-diagnosis
- 24 Factor one
- 26 Inductive power clamp sensors
- 27 High pressure resistant speed monitoring
- 27 High protection type

28 Capacitive sensors

- 30 Standard function
- 33 Time delay function
- 33 Extended sensing distance
- 35 Corrosion resistance test
- 36 Pipe liquid level detecting
- 37 High temperature resistant material level detecting

38 Photoelectric sensors

- 40 Through beam
- 47 Retro reflection
- 48 Polarized reflection
- 49 Transparent object detection
- 50 Diffuse reflection
- 53 Background suppression

55	Focus reflection
55	TOF reflection
56	Mark sensors
57	Optical fiber sensors
60	Color sensors

61 Measuring sensors

61	Digital laser distance sensors
65	Laser distance sensors
66	Digital laser displacement sensors
69	Laser displacement sensors
70	CCD laser diameter measurement
71	Thin gas pressure sensor

72 Light curtains

74	Area light curtains
76	Measuring light curtains

78 Tension sensors

80 Sensor accessories

82	Connection cables
84	Connectors
86	Distribution boxes
88	Mounting brackets
92	Reflectors

93 Wiring diagram

Inductive sensors



- Contactless, no abrasion, high reliability.
- LED indicator.
- Diameter from $\Phi 4$ to M30, multi lengths available, square specifications from 5*5 to 80*80.
- Cable and connector connection optional.
- Stable performance with professional IC design.
- With short circuit protection, reverse polarity protection, overload protection and surge protection.
- Widely applied in position controlling and counting function.

Naming rules

L **R** **08** □ □ □ **F** **15** **D** **N** **O** □ - □ □ □ □ □ □ □ □

1 **2** **3** **4** **5** **6** **7** **8** **9** **10** **11** **12** **13** **14** **15**

1. Type code

L: Inductive

2. Shape code

R: Cylindrical
E: Rectangular

3. Size code

Number: Housing diameter
e.g: 08:M8

4. Shape code

Q: Smooth cylindrical
V: Angle column
Z: Combination
H: Ring-shaped
U: U-shaped
X: Appearance improved/function enhanced products

5. Housing material

N/A: Copper
S: Plastic
G: Stainless steel
V: Aluminium

6. Housing length

A: Short
B: Standard
C: Long

7. Mounting

N: Non-flush(nf)
F: Flush(f)

8. Sensing distance

Digital: Sensing distance
e.g: 02:2mm
04:4mm
10:10mm

9. Supply voltage

A: 20...250VAC
B: 90...250VAC
D: 10...30VDC
E: 10...60VDC
F: 8.2VDC
L: 15...30VDC
H: 20...30VDC
S: 20...250VAC/DC

10. Output way

B: AC/DC 2 wires
L: DC 2 wires
T: AC 2 wires
P: PNP
N: NPN

11. Output status

B: NO/NC Optional
O: NO
C: NC
R: NO+NC
IU: Voltage+ current (0...10V, 0...20mA)
U: Voltage(0...10V)
I: Current(0...20mA)
I4: Current(4...20mA)
L: IO Link

12. By sensor function

N/A: Standard function
M: Analog
N: NAMUR
W: High temperature resistant(-25°C...120°C)
W1: Low temperature resistant(-40°C...70°C)
W2: High temperature resistant(-25°C...100°C)
B: High pressure resistant
Z: Self-diagnosis
Y: Extended sensing distance
G: Frequency enhanced
Q: Full metal housing
A: Welding-immune
J: Rotation speed monitoring

13. Cable length

e.g: N/A: 2m
3M: 3m

14. Connection

N/A: 2m cable
E1: M8 connector (3 pins)
E2: M12 connector (4 pins)
E3: M8 connector (4 pins)
D: Terminal
F1: M8 connector (3 pins)+0.2m cable
F2: M12 connector (4 pins)+0.2m cable

15. Special requirement

In 4 digits

Standard function



Shell code	LR04Q	LR05	LR6.5Q	LR08	LR12X	
Dimensions(mm)	Φ4*30, Φ4*54	M5*0.5*30, M5*0.5*40	Φ6.5*40, Φ6.5*43 Φ6.5*49, Φ6.5*52	M8*1*40, M8*1*43 M8*1*49, M8*1*52 M8*1*65, M8*1*68	M12*1*51, M12*1*55	
Mounting	● Flush	● Flush	● Flush, ○ Non-flush	● Flush, ○ Non-flush	● Flush, ○ Non-flush	
Sensing distance	0.8mm	0.8mm	1.5mm, 2mm	1.5mm, 2mm	2mm, 4mm	
Output	DC 3 Wires	NPN NO; NPN NC PNP NO; PNP NC	NPN NO; NPN NC PNP NO; PNP NC	NPN NO; NPN NC PNP NO; PNP NC	NPN NO; NPN NC PNP NO; PNP NC	NPN NO; NPN NC PNP NO; PNP NC
	DC 4 Wires	/	/	/	/	NPN NO+NC PNP NO+NC
	DC 2 Wires	/	/	NO NC	NO NC	NO NC
	AC 2 Wires	/	/	/	/	NO NC
	AC/DC 2 Wires	/	/	/	/	/
Supply voltage	10...30 VDC	10...30 VDC	10...30 VDC	10...30 VDC	10...30 VDC 20...250 VAC	
Frequency	2000Hz	2000Hz	2000Hz, 1500Hz	2000Hz, 1500Hz	DC3/4: 1500Hz, 1000Hz DC2: 800Hz, 500Hz AC2: 20Hz	
Ambient temperature	-25°C...70°C	-25°C...70°C	-25°C...70°C	-25°C...70°C	-25°C...70°C	
Protection degree	IP67	IP67	IP67	IP67	IP67	
Housing material	Stainless steel	Stainless steel	Stainless steel	Stainless steel Nickel-copper Alloy	Nickel-copper Alloy	
Connection	Cable, M8 Connector	Cable, M8 Connector	Cable, M8 Connector	Cable M8/M12 Connector	Cable	
Certification	CE UK UL	CE UK UL	CE UK UL	CE UK UL	CE UK UL CC	

Standard function



Shell code	LR18X	LR30X	LR12X	LR18X	LR30X	
Dimensions(mm)	M18*1*51.5 M18*1*59.5	M30*1.5*52 M30*1.5*64	M12*1*63 M12*1*67	M18*1*63 M18*1*71	M30*1.5*63 M30*1.5*75	
Mounting	● Flush, ○ Non-flush	● Flush, ○ Non-flush	● Flush, ○ Non-flush	● Flush, ○ Non-flush	● Flush, ○ Non-flush	
Sensing distance	5mm, 8mm	10mm, 15mm	2mm, 4mm	5mm, 8mm	10mm, 15mm	
Output	DC 3 Wires	NPN NO; NPN NC PNP NO; PNP NC	NPN NO; NPN NC PNP NO; PNP NC	NPN NO; NPN NC PNP NO; PNP NC	NPN NO; NPN NC PNP NO; PNP NC	NPN NO; NPN NC PNP NO; PNP NC
	DC 4 Wires	NPN NO+NC PNP NO+NC	NPN NO+NC PNP NO+NC	NPN NO+NC PNP NO+NC	NPN NO+NC PNP NO+NC	NPN NO+NC PNP NO+NC
	DC 2 Wires	NO NC	NO NC	NO NC	NO NC	NO NC
	AC 2 Wires	NO NC	NO NC	NO NC	NO NC	NO NC
	AC/DC 2 Wires	NO NC	NO NC	/	NO NC	NO NC
Supply voltage	10...30 VDC 20...250 VAC 20...250 VAC/DC	10...30 VDC	10...30 VDC 20...250 VAC	10...30 VDC 20...250 VAC 20...250 VAC/DC	10...30 VDC 20...250 VAC 20...250 VAC/DC	
Frequency	DC3/4: 1000Hz, 800Hz DC2: 500Hz, 300Hz AC2: 20Hz	DC3/4: 500Hz, 300Hz DC2: 200Hz AC2: 20Hz	DC3/4: 1500Hz, 1000Hz DC2: 800Hz, 500Hz AC2: 20Hz	DC3/4: 1000Hz, 800Hz DC2: 500Hz, 300Hz AC2: 20Hz	DC3/4: 500Hz, 300Hz DC2: 200Hz AC2: 20Hz	
Ambient temperature	-25°C...70°C	-25°C...70°C	-25°C...70°C	-25°C...70°C	-25°C...70°C	
Protection degree	IP67	IP67	IP67	IP67	IP67	
Housing material	Nickel-copper Alloy	Nickel-copper Alloy	Nickel-copper Alloy	Nickel-copper Alloy	Nickel-copper Alloy	
Connection	Cable	Cable	M12 Connector	M12 Connector	M12 Connector	
Certification	CE UK	CE UK	CE UK	CE UK	CE UK	

Standard function



Shell code	LE40XZ	LE80XZ	LE05	LE81	LE82	
Dimensions(mm)	40*40*120, 40*40*129	40*80*98, 40*80*104	5*5*25	8*8*40, 8*8*50	8*8*40, 8*8*50	
Mounting	● Flush, ○ Non-flush	● Flush, ○ Non-flush	● Flush	● Flush	● Flush	
Sensing distance	15mm,20mm	40mm, 50mm	0.8mm	1.5mm	1.5mm	
Output	DC 3 Wires	NPN NO; NPN NC PNP NO; PNP NC	NPN NO; NPN NC PNP NO; PNP NC	NPN NO; NPN NC PNP NO; PNP NC	NPN NO; NPN NC PNP NO; PNP NC	NPN NO; NPN NC PNP NO; PNP NC
	DC 4 Wires	NPN NO+NC PNP NO+NC	NPN NO+NC PNP NO+NC	/	/	/
	DC 2 Wires	NO NC	NO NC	NO NC	/	/
	AC 2 Wires	NO NC	NO NC	/	/	/
	AC/DC 2 Wires	NO NC	NO NC	/	/	/
Supply voltage	10...30 VDC 20...250 VAC 20...250 VAC/DC	10...30 VDC 20...250 VAC 20...250 VAC/DC	10...30 VDC	10...30 VDC	10...30 VDC	
Frequency	DC3/4: 500Hz, 300Hz DC2: 500Hz, 300Hz AC2: 20Hz	DC3/4: 100Hz, 50Hz DC2: 100Hz, 50Hz AC2: 10Hz	1800Hz	2000Hz	2000Hz	
Ambient temperature	-25°C...70°C	-25°C...70°C	-25°C...70°C	-25°C...70°C	-25°C...70°C	
Protection degree	IP67	IP67	IP67	IP67	IP67	
Housing material	PBT	PBT	Aluminum alloy	Aluminum alloy	Aluminum alloy	
Connection	M12 Connector Terminal connect	M12 Connector Terminal connect	Cable, M8 Trunk line type	Cable, M8 Connector	Cable, M8 Connector	
Certification	CE UK	CE UK	CE UK	CE UK	CE UK	

Standard Function Type-Intrinsically Safe Series



Shell code	LR05	LR6.5Q	LR08	LR12X	LR18X
Dimensions(mm)	M5*0.5*30	M5*6.5*22 M5*6.5*25	M8*1*22, M8*1*25	M12*1*31, M12*1*35	M18*1*31.5 M18*1*39.5
Mounting	● Flush	● Flush, ○ Non-flush	● Flush, ○ Non-flush	● Flush, ○ Non-flush	● Flush, ○ Non-flush
Sensing distance	0.8mm	1.5mm, 2mm	1.5mm, 2mm	2mm, 4mm	5mm, 8mm
Output	NAMUR	NC	NC	NC	NC
	DC 3 Wires	/	/	/	/
	DC 4 Wires	/	/	/	/
	DC 2 Wires	/	/	/	/
	AC 2 Wires	/	/	/	/
Supply voltage	7.7...9 VDC	7.7...9 VDC	7.7...9 VDC	7.7...9 VDC	7.7...9 VDC
Frequency	3000Hz	3000Hz	2500Hz, 2000Hz	2000Hz, 1500Hz	1500Hz, 1000Hz
Ambient temperature	-25°C...70°C	-25°C...70°C	-25°C...70°C	-25°C...70°C	-25°C...70°C
Protection degree	IP67	IP67	IP67	IP67	IP67
Housing material	Stainless steel	Stainless steel	Stainless steel	Nickel-copper Alloy	Nickel-copper Alloy
Connection	Cable	Cable	Cable	Cable	Cable
Certification	—	—	—	—	—

Standard Function Type-Intrinsically Safe Series



Shell code	LR30X	LE40SZ	LE40XZ	LE80XZ	
Dimensions(mm)	M30*1.5*32 M30*1.5*44	40*40*66	40*40*120, 40*40*129	40*80*98, 40*80*104	
Mounting	● Flush, ○ Non-flush	● Flush, ○ Non-flush	● Flush, ○ Non-flush	● Flush, ○ Non-flush	
Sensing distance	10mm, 15mm	15mm, 20mm	15mm, 20mm	40mm, 50mm	
Output	NAMUR	NC	NC	NC	
	DC 3 Wires	/	/	/	
	DC 4 Wires	/	/	/	
	DC 2 Wires	/	/	/	
	AC 2 Wires	/	/	/	
Supply voltage	7.7...9 VDC	7.7...9 VDC	7.7...9 VDC	7.7...9 VDC	
Frequency	1000Hz, 800Hz	400Hz, 250Hz	400Hz, 250Hz	100Hz	
Ambient temperature	-25°C...70°C	-25°C...70°C	-25°C...70°C	-25°C...70°C	
Protection degree	IP67	IP67	IP67	IP67	
Housing material	Nickel-copper Alloy	PBT	PBT	PBT	
Connection	Cable	M12 Connector	M12 Connector Terminal connect	M12 Connector Terminal connect	
Certification	—	—	—	—	

Frequency enhanced

Extended sensing distance



Shell code	LR12X	LR18X	LR04Q	LR05	LR6.5Q
Dimensions(mm)	M12*1*61, M12*1*65 M12*1*73, M12*1*77	M18*1*61.5, M18*1*69.5 M18*1*73, M18*1*81	Φ4*30, Φ4*54	M5*0.5*30, M5*0.5*40	Φ6.5*40, Φ6.5*43 Φ6.5*49, Φ6.5*52
Mounting	● Flush, ○ Non-flush	● Flush, ○ Non-flush	● Quasi-flush	● Quasi-flush	● Quasi-flush ○ Non-flush
Sensing distance	2mm, 4mm	5mm, 8mm	1.5mm	1.5mm	2mm, 4mm
Output	DC 3 Wires	NPN NO; NPN NC PNP NO; PNP NC	NPN NO; NPN NC PNP NO; PNP NC	NPN NO; NPN NC PNP NO; PNP NC	NPN NO; NPN NC PNP NO; PNP NC
	DC 4 Wires	/	/	/	NO NC
	DC 2 Wires	/	/	/	/
	AC 2 Wires	/	/	/	/
Supply voltage	10...30 VDC	10...30 VDC	10...30 VDC	10...30 VDC	10...30 VDC
Frequency	4000Hz, 3000Hz	2000Hz, 1500Hz	1200Hz	1200Hz	DC3/4: 1500Hz, 1000Hz DC2: 1500Hz, 1000Hz
Ambient temperature	-25°C...70°C	-25°C...70°C	-25°C...70°C	-25°C...70°C	-25°C...70°C
Protection degree	IP67	IP67	IP67	IP67	IP67
Housing material	Nickel-copper Alloy	Nickel-copper Alloy	Stainless steel	Stainless steel	Stainless steel
Connection	Cable, M12 Connector	Cable, M12 Connector	Cable, M8 Connector	Cable, M8 Connector	Cable M8/M12 Connector
Certification	CE UK RoHS	CE UK RoHS	CE UK RoHS	CE UK RoHS	CE UK RoHS

Extended sensing distance



Shell code	LR08	LR12X	LR18X	LR30X	
Dimensions(mm)	M8*1*40, M8*1*54 M8*1*65	M12*1*51, M12*1*55 M12*1*63, M12*1*67 M12*1*61, M12*1*65 M12*1*73, M12*1*77	M18*1*51.5, M18*1*59.5 M18*1*63, M18*1*71 M18*1*61.5, M18*1*69.5 M18*1*73, M18*1*81	M30*1.5*52, M30*1.5*64 M30*1.5*63, M30*1.5*75 M30*1.5*62, M30*1.5*74 M30*1.5*73, M30*1.5*85	
Mounting	● Quasi-flush ○ Non-flush	● Quasi-flush ○ Non-flush	● Quasi-flush ○ Non-flush	● Quasi-flush ○ Non-flush	
Sensing distance	2mm, 4mm	4mm, 6mm 8mm, 10mm	8mm, 12mm, 20mm	15mm, 22mm, 40mm	
Output	DC 3 Wires	NPN NO; NPN NC PNP NO; PNP NC	NPN NO; NPN NC PNP NO; PNP NC	NPN NO; NPN NC PNP NO; PNP NC	NPN NO; NPN NC PNP NO; PNP NC
	DC 4 Wires	/	NPN NO+NC PNP NO+NC	NPN NO+NC PNP NO+NC	NPN NO+NC PNP NO+NC
	DC 2 Wires	NO NC	NO NC	NO NC	NO NC
	AC 2 Wires	/	/	NO NC	NO NC
	AC/DC 2 Wires	/	/	NO NC	NO NC
Supply voltage	10...30 VDC	10...30 VDC 20...250 VAC	10...30 VDC 20...250 VAC 20...250 VAC/DC	10...30 VDC 20...250 VAC 20...250 VAC/DC	
Frequency	DC3/4: 1500Hz, 1000Hz DC2: 1500Hz, 1000Hz	DC3/4: 800Hz, 500Hz 600Hz, 400Hz DC2: 800Hz, 500Hz AC2: 20Hz	DC3/4: 400Hz, 200Hz 200Hz, 100Hz DC2: 400Hz, 200Hz AC2: 20Hz	DC3/4: 300Hz, 150Hz 100Hz, 50Hz DC2: 300Hz, 150Hz AC2: 20Hz	
Ambient temperature	-25°C...70°C	-25°C...70°C	-25°C...70°C	-25°C...70°C	
Protection degree	IP67	IP67	IP67	IP67	
Housing material	Stainless steel	Nickel-copper Alloy	Nickel-copper Alloy	Nickel-copper Alloy	
Connection	Cable M8/M12 Connector	Cable, M12 Connector	Cable, M12 Connector	Cable, M12 Connector	
Certification	CE UK	CE UK	CE UK	CE UK	

Extended sensing distance



Shell code	LE68	LE40SZ	LE40XZ	LE80XZ	
Dimensions(mm)	20 *40 *68mm	40*40*66	40*40*120, 40*40*129	40*80*98, 40*80*104	
Mounting	● Flush, ○ Non-flush	● Quasi-flush ○ Non-flush	● Quasi-flush ○ Non-flush	● Quasi-flush ○ Non-flush	
Sensing distance	22mm	25mm, 40mm	25mm, 40mm	50mm, 70mm	
Output	DC 3 Wires	NPN NO; NPN NC PNP NO; PNP NC	NPN NO; NPN NC PNP NO; PNP NC	NPN NO; NPN NC PNP NO; PNP NC	NPN NO; NPN NC PNP NO; PNP NC
	DC 4 Wires	/	NPN NO+NC PNP NO+NC	NPN NO+NC PNP NO+NC	NPN NO+NC PNP NO+NC
	DC 2 Wires	/	NO NC	NO NC	NO NC
	AC 2 Wires	/	NO NC	NO NC	NO NC
	AC/DC 2 Wires	/	NO NC	NO NC	NO NC
Supply voltage	10...30 VDC	10...30 VDC 20...250 VAC 20...250 VAC/DC	10...30 VDC 20...250 VAC 20...250 VAC/DC	10...30 VDC 20...250 VAC 20...250 VAC/DC	
Frequency	200Hz	DC3/4: 200Hz, 100Hz DC2: 200Hz, 100Hz AC2: 20Hz	DC3/4: 200Hz, 100Hz DC2: 200Hz, 100Hz AC2: 20Hz	DC3/4: 50Hz, 30Hz DC2: 50Hz, 30Hz AC2: 20Hz	
Ambient temperature	-25°C...70°C	-25°C...70°C	-25°C...70°C	-25°C...70°C	
Protection degree	IP67	IP67	IP67	IP67	
Housing material	PBT	PBT	PBT	PBT	
Connection	Cable, M12 Connector	M12 Connector	M12 Connector Terminal connect	M12 Connector Terminal connect	
Certification	CE UK	CE UK	CE UK	CE UK	

Analog output



Shell code	LR12X	LR18X	LR30X	LE40SZ	LE40XZ
Dimensions(mm)	M12*1*61,M12*1*65 M12*1*73,M12*1*77	M18*1*61.5,M18*1*69.5 M18*1*73,M18*1*81	M30*1.5*62,M30*1.5*74 M30*1.5*73,M30*1.5*85	40*40*66	40*40*120, 40*40*129
Mounting	● Flush, ○ Non-flush	● Flush, ○ Non-flush	● Flush, ○ Non-flush	● Flush, ○ Non-flush	● Flush, ○ Non-flush
Sensing distance	0.4...2mm 0.8...4mm	1...5mm 1.6...8mm	2...10mm 3...15mm	2...10mm 3...15mm	2...10mm 3...15mm
Voltage output	0...10V	0...10V	0...10V	0...10V	0...10V
Output	Current output	0...20mA/4...20mA	0...20mA/4...20mA	0...20mA/4...20mA	0...20mA/4...20mA
	Voltage+Current output	0...10V+0...20mA	0...10V+0...20mA	0...10V+0...20mA	0...10V+0...20mA
Supply voltage	15...30 VDC	15...30 VDC	15...30 VDC	15...30 VDC	15...30 VDC
Frequency	200Hz, 100Hz	200Hz, 100Hz	200Hz, 100Hz	100Hz, 50Hz	100Hz, 50Hz
Ambient temperature	-25°C...70°C	-25°C...70°C	-25°C...70°C	-25°C...70°C	-25°C...70°C
Protection degree	IP67	IP67	IP67	IP67	IP67
Housing material	Nickel-copper Alloy	Nickel-copper Alloy	Nickel-copper Alloy	PBT	PBT
Connection	Cable, M12 Connector	Cable, M12 Connector	Cable, M12 Connector	M12 Connector	M12 Connector Terminal connect
Certification	CE UK	CE UK	CE UK	CE UK	CE UK

Extended temperature



Shell code	LR12X	LR18X	LR30X	LE40SZ	LE40XZ
Dimensions(mm)	M12*1*51,M12*1*55 M12*1*63,M12*1*67	M18*1*51.5,M18*1*59.5 M18*1*63,M18*1*71	M30*1.5*52,M30*1.5*64 M30*1.5*63,M30*1.5*75	40*40*66	40*40*120, 40*40*129
Mounting	● Flush, ○ Non-flush	● Flush, ○ Non-flush	● Flush, ○ Non-flush	● Flush, ○ Non-flush	● Flush, ○ Non-flush
Sensing distance	2mm, 4mm	5mm, 8mm	10mm, 15mm	15mm, 20mm	15mm, 20mm
Output	DC 3 Wires	NPN NO; NPN NC PNP NO; PNP NC	NPN NO; NPN NC PNP NO; PNP NC	NPN NO; NPN NC PNP NO; PNP NC	NPN NO; NPN NC PNP NO; PNP NC
	DC 4 Wires	/	/	/	/
	DC 2 Wires	/	/	/	/
	AC 2 Wires	/	/	/	/
	AC/DC 2 Wires	/	/	/	/
Supply voltage	10...30 VDC	10...30 VDC	10...30 VDC	10...30 VDC	10...30 VDC
Frequency	1500Hz, 1000Hz	1000Hz, 800Hz	5000Hz, 300Hz	300Hz, 200Hz	300Hz, 200Hz
Ambient temperature	-40°C...70°C -25°C...120°C	-40°C...70°C -25°C...120°C	-40°C...70°C -25°C...120°C -25...180°C	-40°C...70°C -25°C...100°C	-40°C...70°C -25°C...100°C
Protection degree	IP67	IP67	IP67	IP67	IP67
Housing material	Nickel-copper Alloy	Nickel-copper Alloy	Nickel-copper Alloy	PBT	PBT
Connection	Cable M12 Connector	Cable M12 Connector	Cable M12 Connector	M12 Connector	M12 Connector Terminal connect
Certification	CE UK	CE UK	CE UK	CE UK	CE UK

High pressure resistant



Shell code	LR12X	LR14X	LR16X	LR18X	
Dimensions(mm)	M12*1*62, M12*1*77	M14*1*54, M14*1*64	M16*1*63, M16*1*73	M18*1*58, M18*1*74	
Mounting	● Flush	● Flush	● Flush	● Flush	
Sensing distance	1.5mm	1.5mm, 3mm	2mm	2mm	
Output	DC 3 Wires	NPN NO; NPN NC PNP NO; PNP NC	NPN NO; NPN NC PNP NO; PNP NC	NPN NO; NPN NC PNP NO; PNP NC	NPN NO; NPN NC PNP NO; PNP NC
	DC 4 Wires	/	/	/	/
	DC 2 Wires	/	/	/	/
	AC 2 Wires	/	/	/	/
	AC/DC 2 Wires	/	/	/	/
Supply voltage	10...30 VDC	10...30 VDC	10...30 VDC	10...30 VDC	
Frequency	600Hz	600Hz	600Hz	200Hz	
Withstand pressure	500Bar	500Bar	500Bar	500Bar	
Ambient temperature	-25°C...70°C	-25°C...80°C	-25°C...80°C	-25°C...80°C	
Protection degree	IP68	IP68	IP68	IP68	
Housing material	Stainless steel	Stainless steel	Stainless steel	Stainless steel	
Connection	Cable, M12 Connector	Cable, M12 Connector	Cable, M12 Connector	Cable, M12 Connector	
Certification	CE UK UL	CE UK UL	CE UK UL	CE UK UL	

Full metal housing



Shell code	LR12X	LR18X	LR30X		
Dimensions(mm)	M12*1*74	M18*1*74	M30*1*74		
Mounting	● Flush, ○ Non-flush	● Flush, ○ Non-flush	● Flush, ○ Non-flush		
Sensing distance	2mm, 4mm	5mm, 8mm	10mm, 15mm		
Output	DC 3 Wires	NPN NO; NPN NC PNP NO; PNP NC	NPN NO; NPN NC PNP NO; PNP NC	NPN NO; NPN NC PNP NO; PNP NC	
	DC 4 Wires	/	/	/	
	DC 2 Wires	/	/	/	
	AC 2 Wires	/	/	/	
	AC/DC 2 Wires	/	/	/	
Supply voltage	10...30 VDC	10...30 VDC	10...30 VDC		
Frequency	300Hz	200Hz	100Hz		
Ambient temperature	-25°C...70°C	-25°C...70°C	-25°C...70°C		
Protection degree	IP67	IP67	IP67		
Housing material	316L Stainless steel	316L Stainless steel	316L Stainless steel		
Connection	M12 Connector	M12 Connector	M12 Connector		
Certification	CE UK UL	CE UK UL	CE UK UL		

Rotation speed monitor



Shell code	LR18X	LR30X			
Dimensions(mm)	M18*1*61.5 M18*1*69.5	M30*1.5*62 M30*1.5*74			
Mounting	● Flush, ○ Non-flush	● Flush, ○ Non-flush			
Sensing distance	5mm, 8mm	10mm, 15mm			
Output	DC 3 Wires	NPN NC PNP NC	NPN NC PNP NC		
	DC 4 Wires	/	/		
	DC 2 Wires	/	/		
	AC 2 Wires	NC	NC		
	AC/DC 2 Wires	/	/		
Supply voltage	10...30 VDC 20...250 VAC	10...30 VDC 20...250 VAC			
Frequency	DC: 3...3000 times/min AC: 3...1200 times/min	DC: 3...3000 times/min AC: 3...1200 times/min			
Ambient temperature	-25°C...70°C	-25°C...70°C			
Protection degree	IP67	IP67			
Housing material	Nickel-copper Alloy	Nickel-copper Alloy			
Connection	Cable	Cable			
Certification	CE UK	CE UK			

Gear speed monitoring



Shell code		FY12		FY18	
Dimensions(mm)		M12*1*61	M12*1*73	M18*1*61.5	M18*1*73
Mounting		● Flush	● Flush	● Flush	● Flush
Sensing distance		2mm	2mm	2mm	2mm
Output	DC 3 Wires	NPN NO; NPN NC PNP NO; PNP NC	NPN NO; NPN NC PNP NO; PNP NC	NPN NO; NPN NC PNP NO; PNP NC	NPN NO; NPN NC PNP NO; PNP NC
	DC 4 Wires	/	/	/	/
	DC 2 Wires	/	/	/	/
	AC 2 Wires	/	/	/	/
	AC/DC 2 Wires	/	/	/	/
Supply voltage		10...30 VDC	10...30 VDC	10...30 VDC	10...30 VDC
Frequency		25000Hz	25000Hz	25000Hz	25000Hz
Ambient temperature		-25°C...70°C	-25°C...70°C	-25°C...70°C	-25°C...70°C
Protection degree		IP67	IP67	IP67	IP67
Housing material		Nickel-copper Alloy	Nickel-copper Alloy	Nickel-copper Alloy	Nickel-copper Alloy
Connection		Cable	M12 Connector	Cable	M12 Connector
Certification		—	—	—	—

Welding-immune



Shell code	LR12X	LR18X	LR30X	LE21	
Dimensions(mm)	M12*1*51,M12*1*55 M12*1*63,M12*1*67	M18*1*51.5,M18*1*59.5 M18*1*63,M18*1*71	M30*1.5*52,M30*1.5*64 M30*1.5*63,M30*1.5*75	26.2*20.2*10.5	
Mounting	● Flush, ○ Non-flush	● Flush, ○ Non-flush	● Flush, ○ Non-flush	● Flush	
Sensing distance	2mm, 4mm	5mm, 8mm	10mm, 15mm	0.3mm	
Output	DC 3 Wires	NPN NO; NPN NC PNP NO; PNP NC	NPN NO; NPN NC PNP NO; PNP NC	NPN NO; NPN NC PNP NO; PNP NC	NPN NO
	DC 4 Wires	/	/	/	/
	DC 2 Wires	/	/	/	/
	AC 2 Wires	/	/	/	/
	AC/DC 2 Wires	/	/	/	/
Supply voltage	10...30 VDC	10...30 VDC	10...30 VDC	10...30 VDC	
Frequency	3000Hz, 2000Hz	1500Hz, 1000Hz	800Hz, 500Hz	500Hz	
Ambient temperature	-25°C...70°C	-25°C...70°C	-25°C...70°C	-25°C...70°C	
Protection degree	IP67	IP67	IP67	IP67	
Housing material	Brass+PTFE	Brass+PTFE	Brass+PTFE	PA66	
Connection	Cable, M12 Connector	Cable, M12 Connector	Cable, M12 Connector	Cable	
Certification	CE UK EA	CE UK EA	CE UK EA	CE UK EA	

Self-diagnosis

Factor one



Shell code	LR12X	LR12X	LR12X	LR18X	LR30X	
Dimensions(mm)	M12*1*70	M12*1*69, M12*1*89	M12*1*51, M12*1*55 M12*1*63, M12*1*67	M18*1*51.5, M18*1*59.5 M18*1*63, M18*1*71	M30*1.5*52, M30*1.5*64 M30*1.5*63, M30*1.5*75	
Mounting	⊙ Non-flush	⊙ Non-flush	● Flush, ⊙ Non-flush	● Flush, ⊙ Non-flush	● Flush, ⊙ Non-flush	
Sensing distance	3.7mm	3.7mm	2mm, 4mm	5mm, 8mm	10mm, 15mm	
Output	DC 3 Wires	PNP NO; PNP NC	PNP NO; PNP NC	NPN NO; NPN NC PNP NO; PNP NC	NPN NO; NPN NC PNP NO; PNP NC	NPN NO; NPN NC PNP NO; PNP NC
	DC 4 Wires	/	/	NPN NO+NC PNP NO+NC	NPN NO+NC PNP NO+NC	NPN NO+NC PNP NO+NC
	DC 2 Wires	/	/	/	/	/
	AC 2 Wires	/	/	/	/	/
	AC/DC 2 Wires	/	/	/	/	/
Supply voltage	20...30 VDC	20...30 VDC	10...30 VDC	10...30 VDC	10...30 VDC	
Frequency	300Hz	300Hz	800Hz, 500Hz	400Hz, 200Hz	300Hz, 150Hz	
Ambient temperature	-25°C...70°C	-25°C...70°C	-25°C...70°C	-25°C...70°C	-25°C...70°C	
Protection degree	IP67	IP67	IP67	IP67	IP67	
Housing material	Nickel-copper Alloy	Nickel-copper Alloy	Nickel-copper Alloy	Nickel-copper Alloy	Nickel-copper Alloy	
Connection	Cable	M12 Connector	Cable, M12 Connector	Cable, M12 Connector	Cable, M12 Connector	
Certification	CE UK	CE UK	—	—	—	

Factor one



Shell code	LE40SZ	LE40XZ			
Dimensions(mm)	40*40*66	40*40*120,40*40*129			
Mounting	● Flush, ○ Non-flush	● Flush, ○ Non-flush			
Sensing distance	15mm, 20mm	15mm, 20mm			
Output	DC 3 Wires	NPN NO; NPN NC PNP NO; PNP NC	NPN NO; NPN NC PNP NO; PNP NC		
	DC 4 Wires	NPN NO+NC PNP NO+NC	NPN NO+NC PNP NO+NC		
	DC 2 Wires	/	/		
	AC 2 Wires	/	/		
	AC/DC 2 Wires	/	/		
Supply voltage	10...30 VDC	10...30 VDC			
Frequency	200Hz, 100Hz	200Hz, 100Hz			
Ambient temperature	-25°C...70°C	-25°C...70°C			
Protection degree	IP67	IP67			
Housing material	PBT	PBT			
Connection	M12 Connector	M12 Connector Terminal connect			
Certification	—	—			

Clamp position series



Shell code	LT18 (V1)	LT18 (V2)	LT18 (V3)	LT18 (V4)	LT20-V1
Dimensions(mm)	47*18*35	47*18*35	47*18*35	47*18*35	18...28mm
Mounting	Ⓞ Non-flush	Ⓞ Non-flush	Ⓞ Non-flush	Ⓞ Non-flush	Ⓞ Non-flush
Sensing distance	2mm	2mm	2mm	2mm	2mm
Output	DC 3 Wires	/	/	/	/
	DC 4 Wires	NPN NO+NO PNP NO+NO	NPN NO+NO PNP NO+NO	NPN NO+NO PNP NO+NO	NPN NO+NO PNP NO+NO
	DC 2 Wires	/	/	/	/
	AC 2 Wires	/	/	/	/
	AC/DC 2 Wires	/	/	/	/
Supply voltage	10...30 VDC	10...30 VDC	10...30 VDC	10...30 VDC	10...30 VDC
Withstand pressure	/	/	/	/	/
Frequency	30Hz	30Hz	30Hz	30Hz	1000Hz
Ambient temperature	-25°C...70°C	-25°C...70°C	-25°C...70°C	-25°C...70°C	-25°C...70°C
Protection degree	IP67	IP67	IP67	IP67	IP67
Housing material	PA66	PA66	PA66	PA66	PA66
Connection	M12 Connector	M12 Connector	M12 Connector	M12 Connector	M12 Connector
Certification	CE UK	CE UK	CE UK	CE UK	CE UK

High pressure resistant speed monitoring

High protection type



Shell code	FYG12	FYG12T	LR18X	LR30X	
Dimensions(mm)	M12*77	M12*77.5	M18*52.5	M30*53	
Mounting	● Flush	● Flush	● Quasi-flush ● Flush	● Flush	
Sensing distance	4mm	2mm	5mm/8mm	10mm/15mm	
Output	DC 3 Wires	NPN NO; NPN NC PNP NO; PNP NC	NPN NO; NPN NC PNP NO; PNP NC	/	/
	DC 4 Wires	/	/	NPN NO; NPN NC PNP NO; PNP NC	NPN NO; NPN NC PNP NO; PNP NC
	DC 2 Wires	/	/	/	/
	AC 2 Wires	/	/	/	/
	AC/DC 2 Wires	/	/	/	/
Supply voltage	10...30 VDC	10...30 VDC	10...30 VDC	10...36 VDC	
Withstand pressure	500Bar	500Bar	1000V/AC 50/60Hz 60s	1000V/AC 50/60Hz 60s	
Frequency	5000Hz	20000Hz	1000 Hz/500 Hz	500 Hz	
Ambient temperature	-30°C...110°C	-40°C...80°C	-40°C...85°C	-40°C...85°C	
Protection degree	IP68	IP68	IP68/IP69K	IP68/IP69K	
Housing material	Stainless steel	Stainless steel	Nickel-copper Alloy	Nickel-copper Alloy	
Connection	M12 Connector	M12 Connector	Cable M12 connector (4 pins)+0.2m cable	Cable M12 connector (4 pins)+0.2m cable	
Certification	CE UK	CE UK	CE UK	CE UK	

Capacitive sensors



- Wide range of detecting targets: metal, plastic and fluid etc.
- Be able to detect different objects in container through nonmetallic container wall.
- Sensibility could be adjusted by potentiometer.

Naming rules

C **R** **12** **□** **B** **F** **02** **D** **N** **O** **□** - **□** **□** **□□□□**
1 **2** **3** **4** **5** **6** **7** **8** **9** **10** **11** **12** **13** **15**

1. Type code

Capacitive

2. Shape code

R: Threaded cylindrical
 Q: Smooth cylindrical
 E: Rectangular

3. Size code

Number: Housing diameter
 e.g: 08:M8

4. Housing material

N/A: Copper
 S: Plastic
 G: Stainless steel

5. Housing length

A: Short
 B: Standard
 C: Long
 D: Super Long

6. Mounting

N: Non-flush(nf)
 F: Flush(f)

7. Sensing distance

Digital: Sensing distance
 e.g: 02:2mm
 04:4mm
 10:10mm

8. Supply voltage

A: 20...250VAC
 D: 10...30VDC
 M: 18...36VDC
 S: 20...250VAC/DC

9. Output way

B: AC/DC 2 wires
 T: AC 2 wires
 P: PNP
 N: NPN
 K: Relay

10. Output status

B: NO/NC optional
 O: NO
 C: NC
 R: R:NO+NC
 Note: Relay output is optional
 L: IO Link

11. By sensor function

N/A: Standard function
 Y: Extended sensing distance
 T1: On-delay function
 T160: 60s
 T1600: 600s
 T2: Off-delay function
 T260: 60s
 T2600: 600s

12. Cable length

e.g: N/A: 2m
 3M: 3m

13. Connection

N/A: 2m cable
 M12 connector (4 pins)
 Terminal

14. Special requirement

In 4 Digits

Standard function



Shell code	CR12	CR18	CR30	CQ20	CQ32
Dimensions(mm)	M12*1*52, M12*1*65	M18*1*70, M18*1*83.5	M30*1.5*62 M30*1.5*79	Φ20*80	Φ32*80
Mounting	● Flush, ○ Non-flush	● Flush, ○ Non-flush	● Flush, ○ Non-flush	● Flush, ○ Non-flush	● Flush, ○ Non-flush
Sensing distance	2mm, 4mm	5mm, 8mm	10mm, 15mm	10mm, 15mm	15mm, 20mm
Output	DC 3 Wires	NPN NO; NPN NC PNP NO; PNP NC	NPN NO; NPN NC PNP NO; PNP NC	NPN NO; NPN NC PNP NO; PNP NC	NPN NO; NPN NC PNP NO; PNP NC
	DC 4 Wires	/	NPN NO+NC PNP NO+NC	NPN NO+NC PNP NO+NC	NPN NO+NC PNP NO+NC
	DC 2 Wires	/	/	/	/
	AC 2 Wires	/	NO NC	NO NC	NO NC
	AC/DC 2 Wires	/	NO NC	NO NC	/
Supply voltage	10...30 VDC	10...30 VDC 20...250 VAC	10...30 VDC 20...250 VAC 20...250 VAC/DC	10...30 VDC 20...250 VAC	10...30 VDC 20...250 VAC 20...250 VAC/DC
Frequency	50Hz	50Hz, 15Hz	50Hz, 15Hz	50Hz, 15Hz	50Hz, 15Hz
Ambient temperature	-25°C...70°C	-25°C...70°C	-25°C...70°C	-25°C...70°C	-25°C...70°C
Protection degree	IP67	IP67	IP67	IP67	IP67
Housing material	Nickel-copper Alloy, PA66	Nickel-copper Alloy, PBT	Nickel-copper Alloy, PBT	Nickel-copper Alloy, PBT	Nickel-copper Alloy, PBT
Connection	Cable, M12 Connector	Cable, M12 Connector	Cable, M12 Connector	Cable	Cable
Certification	CE UK	CE UK	CE UK	CE UK	CE UK

Standard function



Shell code	CQ345	CR30X	CQ32X	CE05	CE05X	
Dimensions(mm)	Φ34*80	M30*64	Φ32*80	50*20*5	30*7*50	
Mounting	● Flush, ○ Non-flush	● Flush	● Flush	○ Non-flush	● Flush, ○ Non-flush	
Sensing distance	15mm, 25mm	10mm	15mm	3.5mm, 5mm, 8mm	3.5mm, 5mm, 8mm	
Output	DC 3 Wires	NPN NO; NPN NC PNP NO; PNP NC	/	/	NPN NO; NPN NC PNP NO; PNP NC	NPN NO; NPN NC PNP NO; PNP NC
	DC 4 Wires	NPN NO+NC PNP NO+NC	/	/	/	/
	DC 2 Wires	NO NC	/	/	/	/
	AC 2 Wires	NO NC	NO NC	/	/	/
	AC/DC 5 Wires	/	/	NO+NC	/	/
Supply voltage	10...30 VDC 20...250 VAC 20...250 VAC/DC	20...250V AC/DC	20...250V AC	10...30 VDC	10...30 VDC	
Frequency	50Hz, 15Hz	/	/	30Hz	60Hz	
Ambient temperature	-25°C...70°C	-25°C...70°C	-25°C...70°C	-25°C...70°C	-10°C...70°C	
Protection degree	IP67	IP68	IP67	IP67	IP67	
Housing material	PBT	PBT	PC/PBT	PBT	PBT	
Connection	Cable	Cable, M12 Connector	Cable	Cable	Cable	
Certification	CE UK	CE UK	CE UK	CE UK	CE UK	

Standard function



Shell code	CE05-S	CE07	CE34	CE35	CE39
Dimensions(mm)	50*20*5	30*7*50	50*7*20	35*15*58	39*59*15
Mounting	① Non-flush	● Flush, ① Non-flush	① Non-flush	● Flush, ① Non-flush	① Non-flush
Sensing distance	6mm(Adjustable)	5mm, 8mm	10mm	10mm, 15mm	12mm
Output	DC 3 Wires	NPN NO; NPN NC PNP NO; PNP NC	NPN NO; NPN NC PNP NO; PNP NC	NPN NO; NPN NC PNP NO; PNP NC	NPN NO; NPN NC PNP NO; PNP NC
	DC 4 Wires	/	/	/	NPN NO+NC PNP NO+NC
	DC 2 Wires	/	/	/	/
	AC 2 Wires	/	/	/	/
	AC/DC 2 Wires	/	/	/	/
Supply voltage	10...30 VDC	10...30 VDC	10...30 VDC	10...30 VDC	10...30 VDC
Frequency	30Hz	60Hz	30Hz	50Hz	50Hz
Ambient temperature	-25°C...70°C	-10°C...70°C	-10°C...70°C	-10°C...70°C	-10°C...70°C
Protection degree	IP67	IP67	IP67	IP67	IP67
Housing material	PBT	PBT	PBT	PBT	PBT
Connection	Cable	Cable	Cable	Cable	Cable
Certification	CE UK	CE UK	CE UK	CE UK	CE UK

Time delay function

Extended sensing distance



Shell code	CR30X	CQ32X	CQ34S	CR12D	CR12X
Dimensions(mm)	M30*64	φ32*80	φ34*80	M12*1*63,M12*1*65.5 M12*1*75,M12*1*80.5	M12*1*63,M12*1*68 M12*1*75,M12*1*80
Mounting	● Flush	● Flush	● Flush, ○ Non-flush	● Flush, ○ Non-flush	● Flush, ○ Non-flush
Sensing distance	10mm	15mm	15mm, 25mm	4mm,8mm	4mm,8mm
Output	DC 3 Wires	/	/	NPN NO; NPN NC PNP NO; PNP NC	NPN NO; NPN NC PNP NO; PNP NC
	DC 4 Wires	/	/	/	/
	DC 2 Wires	/	/	/	/
	AC 2 Wires	/	/	/	/
	AC 5 Wires	NO NC	NO NC	Relay output NO+NC	/
Supply voltage	20...250V AC/DC	20...250V AC	20...250 VAC	10...30 VDC	10...30 VDC
Frequency	/	/	1Hz	40Hz	25Hz
Ambient temperature	-25°C...70°C	-25°C...70°C	-25°C...70°C	-25°C...70°C	-25°C...70°C
Protection degree	IP68	IP67	IP67	IP67	IP67
Housing material	PBT	PC/PBT	PBT	Nickel-copper Alloy	Nickel-copper Alloy
Connection	Cable	Cable	Cable	Cable, M12 Connector	Cable, M12 Connector
Certification	—	—	—	CE UK	CE UK

Extended sensing distance



Shell code	CR18X	CR30X	CR12XS	CR18XS	CR30XS
Dimensions(mm)	M18*1*70,M18*1*85 M18*1*80,M18*1*95	M30*1.5*64,M30*1.5*81 M30*1.5*79,M30*1.5*96	M12*1*62,M12*1*67 M12*1*74,M12*1*79	M18*1*70,M18*1*85 M18*1*80,M18*1*95	M30*1.5*64,M30*1.5*81 M30*1.5*79,M30*1.5*96
Mounting	● Flush, ○ Non-flush	● Flush, ○ Non-flush	● Flush, ○ Non-flush	● Flush, ○ Non-flush	● Flush, ○ Non-flush
Sensing distance	8mm, 12mm	15mm, 25mm	4mm,8mm	8mm, 12mm	15mm, 25mm
Output	DC 3 Wires	NPN NO; NPN NC PNP NO; PNP NC	NPN NO; NPN NC PNP NO; PNP NC	NPN NO; NPN NC PNP NO; PNP NC	NPN NO; NPN NC PNP NO; PNP NC
	DC 4 Wires	NPN NO+NC PNP NO+NC	NPN NO+NC PNP NO+NC	/	NPN NO+NC PNP NO+NC
	DC 2 Wires	/	/	/	/
	AC 2 Wires	/	/	/	/
	AC 5 Wires	/	/	/	/
Supply voltage	10...30 VDC	10...30 VDC	10...30 VDC	10...30 VDC	10...30 VDC
Frequency	25Hz	40Hz	40Hz	25Hz	20Hz
Ambient temperature	-25°C...70°C	-25°C...70°C	-25°C...70°C	-25°C...70°C	-25°C...70°C
Protection degree	IP67	IP67	IP68	IP68	IP68
Housing material	Nickel-copper Alloy	Nickel-copper Alloy	PBT	PBT	PBT
Connection	Cable, M12 Connector	Cable, M12 Connector	Cable, M12 Connector	Cable, M12 Connector	Cable, M12 Connector
Certification	CE UK	CE UK	CE UK	CE UK	CE UK

Corrosion resistance test



Shell code	CR18XT	CR18XT	CR18XT		
Dimensions(mm)	M18*80	M18*70.8	M18*70.8		
Mounting	⊙ Non-flush	● Flush, ⊙ Non-flush	● Quasi-flush ⊙ Non-flush		
Sensing distance	5mm(Contact use)	5mm/8mm	8mm/12mm		
Output	DC 3 Wires	NPN NO; NPN NC PNP NO; PNP NC	NPN NO; NPN NC PNP NO; PNP NC	NPN NO; NPN NC PNP NO; PNP NC	
	DC 4 Wires	NPN NO+NC PNP NO+NC	NPN NO+NC PNP NO+NC	NPN NO+NC PNP NO+NC	
	DC 2 Wires	/	/	/	
	AC 2 Wires	/	/	/	
	AC/DC 2 Wires	/	/	/	
Supply voltage	10...30 VDC	10...30 VDC	10...30 VDC		
Frequency	/	20Hz	20Hz		
Ambient temperature	-25°C...70°C	-25°C...70°C	-25°C...70°C		
Protection degree	IP67	IP67	IP67		
Housing material	PTEE	PTEE	PTEE		
Connection	Cable	Cable	Cable		
Certification	CE UK UL	CE UK UL	CE UK UL		

Pipe liquid level detecting



Shell code	CE10	CE15			
Dimensions(mm)	43*24*20	34*33*20			
Mounting	ⓘ Non-flush	ⓘ Non-flush			
Sensing distance	13mm	26mm			
Output	DC 3 Wires	NPN NO; NPN NC PNP NO; PNP NC	NPN NO; NPN NC PNP NO; PNP NC		
	DC 4 Wires	/	/		
	DC 2 Wires	/	/		
	AC 2 Wires	/	/		
	AC/DC 2 Wires	/	/		
Supply voltage	10...30 VDC	10...30 VDC			
Frequency	60Hz	60Hz			
Ambient temperature	-10°C...55°C	-10°C...55°C			
Protection degree	IP67	IP67			
Housing material	PBT	PBT			
Connection	Cable	Cable			
Certification	CE UK	CE UK			

High temperature resistant material level detecting



Shell code	CE53(Long)	CE53(Short)			
Dimensions(mm)	95.5*55*22	95.5*55*22			
Mounting	⊙ Non-flush	⊙ Non-flush			
Sensing distance	8mm	8mm			
Output	DC 3 Wires	NPN NO; NPN NC PNP NO; PNP NC	NPN NO; NPN NC PNP NO; PNP NC		
	DC 4 Wires	/	/		
	DC 2 Wires	/	/		
	AC 2 Wires	/	/		
	AC/DC 2 Wires	/	/		
Supply voltage	18...36 VDC	18...36 VDC			
Frequency	0.3Hz	0.3Hz			
Ambient temperature	Sensor : 250°C Control box : 0°C...60°C	Sensor : 250°C Control box : 0°C...60°C			
Protection degree	IP54	IP54			
Housing material	PA6	PA6			
Connection	Cable	Cable			
Certification	CE UK	CE UK			

Photoelectric sensors



- Easy to set up and adjust distance.
- Short-circuit protection, reverse polarity protection.
- Cable and connector connection optional.
- Stainless steel housing, strong and durable. Plastic housing, economical and easy to install.
- Light ON/dark ON conversion function.
- Built-in power supply, AC, DC or AC/DC universal power supply.
- Relay output, capacity up to 250VAC*3A.

Naming rules

P **R** **12** **□** **□** - **B** **C15** **D** **N** **O** **□** - **□□** **□□** **□□□□**
1 **2** **3** **4** **5** **6** **7** **8** **9** **10** **11** **12** **13** **14**

1. Type code

P: Photoelectric

2. Shape code

R: Threaded cylindrical
 U: U-Shaped
 Q: Smooth cylindrical
 2 letters: Rectangular housing code
 TE TF TB SE SS
 SM SR SV ST

3. Size Code

Number: Housing diameter
 e.g: 08:M8

4. Housing material

N/A: Copper
 S: Plastic

5. Housing length

N/A: Standard
 Short: S
 Long: L

6. Mounting

B: Diffuse reflection
 D: Retro reflection
 P: Polarized reflection
 S: Focus reflection
 T: Through beam reflection
 M: Color mark detect
 Y: Background suppression
 G: Glass bottle detection

7. Sensing distance

e.g: C10:10cm
 C40:40cm
 M5:5m
 M10:10m
 R50:50mm

8. Supply voltage

A: 20...250VAC
 A2: 220VAC
 B: 90...250VAC
 C: 380VAC
 D: 10...30VDC
 J: 5VDC
 S: 20...240VAC/DC
 T: 12...24VDC

9. Output way

T: AC 2 wires
 P: PNP
 N: NPN
 E: NPN/PNP
 F: NPN+PNP
 K: Relay
 G: Push-Pull

10. Output status

O: NO
 C: NC
 R: NO+NC
 A: NO/NC Reversible
 B: NO/NC Optional
 Cable optional; Potentiometer optional
 Note: Relay output is optional
 L: IO Link

11. Light source type

No: Infrared light source
 R: Red light source
 L: Laser light source
 X: Line light source

12. Cable length

e.g: N/A: 2m
 3M: 3m

13. Connection

N/A: 2m cable
 E1: M8 connector (3 pins)
 E2: M12 connector (4 pins)
 E3: M8 connector (4 pins)
 E4: M12 trapezoid connector (4 pins)
 E5: M12 connector (5 pins)
 D: Terminal
 F3: M8 connector (3 pins)+0.2m cable

14. Special requirement

In 4 digits

Through beam



Shell code	PR12	PR18	PSM	PSS	PR18G	
Sensing distance	5m, 10m	10m, 20m	20m	20m	10m, 20m	
Output	DC 3 Wires	NPN NO; NPN NC PNP NO; PNP NC	NPN NO; NPN NC PNP NO; PNP NC	/	/	NPN NO; NPN NC PNP NO; PNP NC
	DC 4 Wires	/	NPN NO+NC PNP NO+NC	NPN NO/NC PNP NO/NC	NPN NO/NC PNP NO/NC	NPN NO+NC PNP NO+NC
	DC 2 Wires	/	/	/	/	/
	AC 2 Wires	/	NO NC	/	/	NO NC
	AC/DC 5 Wires	/	/	/	/	/
Supply voltage	10...30 VDC	10...30 VDC 20...250 VAC	10...30 VDC	10...30 VDC	10...30 VDC 20...250 VAC	
Response time	DC: <8.2ms	DC: <8.2ms AC: <50 ms	DC: ≤1ms	DC: ≤1ms	DC: <8.2ms AC: <50 ms	
Ambient temperature	-15°C...55°C	-15°C...55°C	-25°C...55°C	-25°C...55°C	-15°C...55°C	
Protection degree	IP67	IP67	IP67	IP67	IP65	
Housing material	Nickel-copper Alloy,PBT	Nickel-copper Alloy,PBT	Nickel-copper Alloy	PC/ABS	Nickel-copper Alloy,PBT	
Connection	Cable M12 Connector	Cable M12 Connector	Cable M12 Connector	Cable M12 Connector	Cable M12 Connector	
Certification	CE UK	CE UK	CE UK	CE UK	CE UK	

Through beam



Shell code	PR30	PR30L			
Sensing distance	20m, 40m	100m, 150m			
Output	DC 3 Wires	NPN NO; NPN NC PNP NO; PNP NC	NPN NO; NPN NC PNP NO; PNP NC		
	DC 4 Wires	NPN NO+NC PNP NO+NC	NPN NO+NC PNP NO+NC		
	DC 2 Wires	/	/		
	AC 2 Wires	NO NC	/		
	AC/DC 5 Wires	/	/		
Supply voltage	10...30 VDC 20...250 VAC	10...30 VDC			
Response time	DC: <8.2ms AC: <50 ms	DC: <8.2ms			
Ambient temperature	-15°C...55°C	-15°C...55°C			
Protection degree	IP67	IP67			
Housing material	Nickel-copper Alloy,PBT	Nickel-copper Alloy,PBT			
Connection	Cable M12 Connector	Cable			
Certification	CE UK ENEC	—			

Through beam



Shell code	PU05M-F	PU05M-K	PU05M-L	PU05M-R	PU05M-T	PU05M-Y
Sensing distance	5mm	5mm	5mm	5mm	5mm	5mm
DC 3 Wires	/	/	/	/	/	/
	NPN NO/NC PNP NO/NC	NPN NO/NC PNP NO/NC	NPN NO/NC PNP NO/NC	NPN NO/NC PNP NO/NC	NPN NO/NC PNP NO/NC	NPN NO/NC PNP NO/NC
	/	/	/	/	/	/
Output	/	/	/	/	/	/
	/	/	/	/	/	/
	/	/	/	/	/	/
Supply voltage	5...24 VDC	5...24 VDC	5...24 VDC	5...24 VDC	5...24 VDC	5...24 VDC
Response time	0.5ms	0.5ms	0.5ms	0.5ms	0.5ms	0.5ms
Ambient temperature	-25°C...55°C	-25°C...55°C	-25°C...55°C	-25°C...55°C	-25°C...55°C	-25°C...55°C
Protection degree	IP64	IP64	IP64	IP64	IP64	IP64
Housing material	PBT	PBT	PBT	PBT	PBT	PBT
Connection	Cable Connector type	Cable Connector type	Cable Connector type	Cable Connector type	Cable Connector type	Cable Connector type
Certification	CE UK	CE UK	CE UK	CE UK	CE UK	CE UK

Through beam



Shell code	PU05S-F	PU05S-K	PU05S-L	PU05S-R	PU05S-U
Sensing distance	5mm	5mm	5mm	5mm	5mm
Output	DC 3 Wires	/	/	/	/
	DC 4 Wires	NPN NO/NC PNP NO/NC	NPN NO/NC PNP NO/NC	NPN NO/NC PNP NO/NC	NPN NO/NC PNP NO/NC
	DC 2 Wires	/	/	/	/
AC 2 Wires	/	/	/	/	/
	AC/DC 5 Wires	/	/	/	/
Supply voltage	5...24 VDC	5...24 VDC	5...24 VDC	5...24 VDC	5...24 VDC
Response time	0.5ms	0.5ms	0.5ms	0.5ms	0.5ms
Ambient temperature	-25°C...55°C	-25°C...55°C	-25°C...55°C	-25°C...55°C	-25°C...55°C
Protection degree	IP64	IP64	IP64	IP64	IP64
Housing material	PBT	PBT	PBT	PBT	PBT
Connection	Cable Connector type	Cable Connector type	Cable Connector type	Cable Connector type	Cable Connector type
Certification	CE UK	CE UK	CE UK	CE UK	CE UK

Through beam



Shell code	PU07	PU13S	PU15	PU30	PU30S	
Sensing distance	7mm	13mm	15mm	30mm	30mm	
Output	DC 3 Wires	NPN NO; NPN NC PNP NO; PNP NC	/	NPN NO; NPN NC PNP NO; PNP NC	/	/
	DC 4 Wires	/	NPN NO/NC PNP NO/NC	/	NPN NO/NC PNP NO/NC	NPN NO+NC PNP NO+NC
	DC 2 Wires	/	/	/	/	/
	AC 2 Wires	/	/	/	/	/
	AC/DC 5 Wires	/	/	/	/	/
Supply voltage	10...30 VDC	10...30 VDC	10...30 VDC	10...30 VDC	10...30 VDC	
Response time	DC: <1ms	DC: <1ms	DC: <1ms	DC: <1ms	DC: <0.6ms	
Ambient temperature	-15°C...55°C	-15°C...55°C	-15°C...55°C	-15°C...55°C	-25°C...55°C	
Protection degree	IP64	IP50	IP64	IP60	IP67	
Housing material	PBT	PBT	PBT	Aluminum alloy+PC	PBT	
Connection	Cable	Cable	Cable	Cable	Cable	
Certification						

Through beam



Shell code	PSV	PSV-S	PST	PSJ	PSE	
Sensing distance	50cm,100cm	50cm,100cm	2m,50cm	1.5m	5m,10m,20m	
Output	DC 3 Wires	NPN NO; NPN NC PNP NO; PNP NC	NPN NO; NPN NC PNP NO; PNP NC	NPN NO; NPN NC PNP NO; PNP NC	NPN NO; NPN NC PNP NO; PNP NC	NPN NO/NC PNP NO/NC
	DC 4 Wires	/	/	/	/	/
	DC 2 Wires	/	/	/	/	/
	AC 2 Wires	/	/	/	/	/
	AC/DC 5 Wires	/	/	/	/	/
Supply voltage	10...30 VDC	10...30 VDC	10...30 VDC	12...24 VDC	10...30 VDC	
Response time	DC: <1ms	DC: <1ms	DC: <0.5ms	DC: <1ms	DC: <1ms	
Ambient temperature	-20°C...55°C	-20°C...55°C	-20°C...55°C	-20°C...55°C	-25°C...55°C	
Protection degree	IP65	IP65	IP65	IP40	IP67	
Housing material	PC+PBT	PC+PBT	ABS	PC/ABS	PC/ABS	
Connection	Cable	Cable	Cable, M8 Trunk line type	Cable	Cable M8 Connector	
Certification	CE UK	CE UK	CE UK	CE UK	CE UK	

Through beam



Shell code	PSR	PTF	PTE	PTL	
Sensing distance	20m	10m, 20m	60m	20m, 30m, 40m	
Output	DC 3 Wires	/	NPN NO; NPN NC PNP NO; PNP NC	/	/
	DC 4 Wires	NPN NO/NC PNP NO/NC	NPN NO+NC PNP NO+NC	NPN+PNP NO/NC	NPN NO+NC PNP NO+NC
	DC 2 Wires	/	/	/	/
	AC 2 Wires	/	/	/	/
	AC/DC 5 Wires	/	Relay output NO+NC	Relay output NO+NC	Relay output NO+NC
Supply voltage	10...30 VDC	10...30 VDC 24...240 VAC/ 12...240 VDC	10...30 VDC 24...240 VAC/DC	10...30 VDC 24...240 VAC/ 12...240 VDC	
Response time	DC: < 1ms	DC: < 8.2ms AC: < 30 ms	DC: < 2ms AC/DC: <10ms	DC: < 8.2ms AC: < 30 ms	
Ambient temperature	-15°C...60°C	-15°C...55°C	-25°C...55°C	-15°C...55°C	
Protection degree	IP67	IP64	IP67	IP67	
Housing material	ABS	PC/ABS	PC/ABS	PC/ABS	
Connection	Cable M12 Connector	Cable M12 Connector	Cable M12 Connector	Terminal	
Certification	CE UK	CE UK	CE UK	CE UK	

Retro reflection



Shell code	PR18	PR18G	PR30	PTL	PST	
Sensing distance	3m	3m	5m	5m	25cm	
Output	DC 3 Wires	NPN NO; NPN NC PNP NO; PNP NC	NPN NO; NPN NC PNP NO; PNP NC	NPN NO; NPN NC PNP NO; PNP NC	/	NPN NO; NPN NC PNP NO; PNP NC
	DC 4 Wires	NPN NO+NC PNP NO+NC	NPN NO+NC PNP NO+NC	NPN NO+NC PNP NO+NC	NPN NO+NC PNP NO+NC	/
	DC 2 Wires	/	/	/	/	/
	AC 2 Wires	NO NC	NO NC	NO NC	/	/
	AC/DC 5 Wires	/	/	/	Relay output NO+NC	/
Supply voltage	10...30 VDC 20...250 VAC	10...30 VDC 20...250 VAC	10...30 VDC 20...250 VAC	10...30 VDC 24...240 VAC/ 12...240 VDC	10...30 VDC	
Response time	DC: < 8.2ms AC: < 50 ms	DC: < 8.2ms AC: < 50 ms	DC: < 8.2ms AC: < 50 ms	DC: < 8.2ms AC: < 30 ms	DC: < 0.5ms	
Ambient temperature	-15°C...55°C	-15°C...55°C	-15°C...55°C	-15°C...55°C	-20°C...55°C	
Protection degree	IP67	IP65	IP67	IP67	IP65	
Housing material	Nickel-copper Alloy,PBT	Nickel-copper Alloy,PBT	Nickel-copper Alloy,PBT	PC/ABS	ABS	
Connection	Cable M12 Connector	Cable M12 Connector	Cable M12 Connector	Terminal	Cable, M8 Trunk line type	
Certification	CE UK UL	CE UK UL	CE UK UL	—	CE UK	

Polarized reflection



Shell code	PSM	PSS	PTL	PSR	PSE	
Sensing distance	3m	3m	12m	3m	3m	
Output	DC 3 Wires	/	/	/	NPN NO/NC PNP NO/NC	
	DC 4 Wires	NPN NO/NC PNP NO/NC	NPN NO/NC PNP NO/NC	NPN NO+NC PNP NO+NC	NPN NO/NC PNP NO/NC	/
	DC 2 Wires	/	/	/	/	/
	AC 2 Wires	/	/	/	/	/
	AC/DC 5 Wires	/	/	Relay output NO+NC	/	/
Supply voltage	10...30 VDC	10...30 VDC	10...30 VDC 24...240 VAC/ 12...240 VDC	10...30 VDC	10...30 VDC	
Response time	DC: ≤0.5ms	DC: ≤0.5ms	DC: < 8.2ms AC: < 30 ms	DC: < 0.5ms	DC: < 0.5ms	
Ambient temperature	-25°C...55°C	-25°C...55°C	-15°C...55°C	-15°C...60°C	-25°C...55°C	
Protection degree	IP67	IP67	IP67	IP67	IP67	
Housing material	Nickel-copper Alloy,PBT	PC/ABS	PC/ABS	ABS	PC/ABS	
Connection	Cable M12 Connector	Cable M12 Connector	Terminal	Cable M12 Connector	Cable M8 Connector	
Certification	CE UK EBC	CE UK EBC	CE UK EBC	CE UK EBC	CE UK EBC	

Transparent object detection



Shell code	PSM	PSS	PSE		
Sensing distance	2m	2m	2m,50cm		
Output	DC 3 Wires	/	/	NPN NO/NC PNP NO/NC	
	DC 4 Wires	NPN NO/NC PNP NO/NC	NPN NO/NC PNP NO/NC	/	
	DC 2 Wires	/	/	/	
	AC 2 Wires	/	/	/	
	AC/DC 5 Wires	/	/	/	
Supply voltage	10...30 VDC	10...30 VDC	10...30 VDC		
Response time	DC: ≤0,5ms	DC: ≤0,5ms	DC: ≤0,5ms		
Ambient temperature	-25°C...55°C	-25°C...55°C	-25°C...55°C		
Protection degree	IP67	IP67	IP67		
Housing material	Nickel-copper Alloy	PC/ABS	PC/ABS		
Connection	Cable M12 Connector	Cable M12 Connector	Cable M8 Connector		
Certification	CE UK	CE UK	CE UK		

Diffuse reflection



Shell code	PR12	PR18	PR18G	PR30	PSM	
Sensing distance	15cm	10cm,40cm	10cm,40cm	50cm,100cm	10cm, 40cm(Infrared light) 40cm, (Red light), 100cm	
Output	DC 3 Wires	NPN NO; NPN NC PNP NO; PNP NC	NPN NO; NPN NC PNP NO; PNP NC	NPN NO; NPN NC PNP NO; PNP NC	NPN NO; NPN NC PNP NO; PNP NC	/
	DC 4 Wires	/	NPN NO+NC PNP NO+NC	NPN NO+NC PNP NO+NC	NPN NO+NC PNP NO+NC	NPN NO/NC PNP NO/NC
	DC 2 Wires	/	/	/	/	/
	AC 2 Wires	/	NO NC	NO NC	NO NC	/
	AC/DC 5 Wires	/	/	/	/	/
Supply voltage	10...30 VDC	10...30 VDC 20...250 VAC	10...30 VDC 20...250 VAC	10...30 VDC 20...250 VAC	10...30 VDC	
Response time	DC: <8.2ms	DC: <8.2ms AC: <50 ms	DC: <8.2ms AC: <50 ms	DC: <8.2ms AC: <50 ms	DC: ≤0.5ms	
Ambient temperature	-15°C...55°C	-15°C...55°C	-15°C...55°C	-15°C...55°C	-25°C...55°C	
Protection degree	IP67	IP67	IP65	IP67	IP67	
Housing material	Nickel-copper Alloy,PBT	Nickel-copper Alloy,PBT	Nickel-copper Alloy,PBT	Nickel-copper Alloy,PBT	Nickel-copper Alloy	
Connection	Cable M12 Connector	Cable M12 Connector	Cable M12 Connector	Cable M12 Connector	Cable M12 Connector	
Certification	CE UK	CE UK	CE UK	CE UK	CE UK	

Diffuse reflection



Shell code	PSS	PBA	PSE	PTF	PTE	
Sensing distance	10cm, 40cm(Infrared light) 40cm, (Red light), 100cm	2m	30cm, 10cm, 100cm	50cm, 100cm	30cm, 200cm	
Output	DC 3 Wires	/	NPN NO; NPN NC PNP NO; PNP NC	NPN NO/NC PNP NO/NC	NPN NO; NPN NC PNP NO; PNP NC	/
	DC 4 Wires	NPN NO/NC PNP NO/NC	/	/	NPN NO+NC PNP NO+NC	NPN+PNP NO/NC
	DC 2 Wires	/	/	/	/	/
	AC 2 Wires	/	/	/	/	/
	AC/DC 5 Wires	/	/	/	Relay output NO+NC	Relay output NO+NC
Supply voltage	10...30 VDC	12...24 VDC	10...30 VDC	10...30 VDC 24...240 VAC/ 12...240 VDC	10...30 VDC 24...240 VAC/DC	
Response time	DC: ≤0.5ms	DC: <3ms	DC: <0.5ms	DC: <8.2ms AC: <30 ms	DC: < 2 ms AC/DC: < 10 ms	
Ambient temperature	-25°C...55°C	-15°C...55°C	-25°C...55°C	-15°C...55°C	-25°C...55°C	
Protection degree	IP67	IP54	IP67	IP64	IP67	
Housing material	PC/ABS	PC/ABS	PC/ABS	PC/ABS	PC/ABS	
Connection	Cable M12 Connector	Cable	Cable M8 Connector	Cable M12 Connector	Cable M12 Connector	
Certification	CE UK EA	—	CE UK EA	CE UK EA	CE UK EA	

Diffuse reflection



Shell code	PTL	PSR	PSV		
Sensing distance	80cm,200cm	30cm	10cm		
DC 3 Wires	/	/	NPN NO; NPN NC PNP NO; PNP NC		
DC 4 Wires	NPN NO+NC PNP NO+NC	NPN NO/NC PNP NO/NC	/		
Output	DC 2 Wires	/	/		
	AC 2 Wires	/	/		
	AC/DC 5 Wires	Relay output NO+NC	/	/	
Supply voltage	10...30 VDC 24...240 VAC/ 12...240 VDC	10...30 VDC	10...30 VDC		
Response time	DC: < 8.2ms AC: < 30 ms	DC: < 0.5ms	DC: < 1ms		
Ambient temperature	-15°C...55°C	-15°C...60°C	-20°C...55°C		
Protection degree	IP67	IP67	IP65		
Housing material	PC/ABS	ABS	PC+PBT		
Connection	Terminal	Cable M12 Connector	Cable		
Certification	—	CE UK CA	CE UK CA		

Background suppression



Shell code	PSM	PSS	PSE	PSE	PSR	
Sensing distance	10cm	10cm	5cm(Background suppression/ Prospects for inhibiting)	25cm,35cm	10cm	
Output	DC 3 Wires	/	/	/	/	
	DC 4 Wires	NPN NO/NC PNP NO/NC	NPN NO/NC PNP NO/NC	NPN NO; NPN NC PNP NO; PNP NC	NPN NO/NC PNP NO/NC	NPN NO/NC PNP NO/NC
	DC 2 Wires	/	/	/	/	
	AC 2 Wires	/	/	/	/	
	AC/DC 5 Wires	/	/	/	/	
Supply voltage	10...30 VDC	10...30 VDC	10...30 VDC	10...30 VDC	10...30 VDC	
Response time	DC: ≤0.5ms	DC: ≤0.5ms	DC: ≤0.5ms	DC: ≤1ms	DC: < 0.5ms	
Ambient temperature	-25°C...55°C	-25°C...55°C	-25°C...55°C	-25°C...55°C	-15°C...60°C	
Protection degree	IP67	IP67	IP67	IP67	IP67	
Housing material	Nickel-copper Alloy	PC/ABS	PC+ABS	PC+ABS	ABS	
Connection	Cable M12 Connector	Cable M12 Connector	Cable M8 Connector	Cable M8 Connector	Cable M12 Connector	
Certification	CE UK CB	CE UK CB	CE UK CB	CE UK CB	CE UK CB	

Background suppression



Shell code	PST	PSV			
Sensing distance	8cm,10cm 15mm,30mm	30mm			
Output	DC 3 Wires	NPN NO; NPN NC PNP NO; PNP NC	NPN NO; NPN NC PNP NO; PNP NC		
	DC 4 Wires	/	/		
	DC 2 Wires	/	/		
	AC 2 Wires	/	/		
	AC/DC 5 Wires	/	/		
Supply voltage	10...30 VDC	10...30 VDC			
Response time	DC: < 1ms	DC: < 1ms			
Ambient temperature	-20°C...55°C	-20°C...55°C			
Protection degree	IP65	IP65			
Housing material	ABS	PC+PBT			
Connection	Cable, M8 Trunk line type	Cable			
Certification	CE UK	CE UK			

Focus reflection

TOF reflection



Shell code	PST	PSV	PSE	PSE	PSE
Sensing distance	25mm	25mm	5cm	60cm, 1m, 3m	3m
DC 3 Wires	NPN NO; NPN NC PNP NO; PNP NC	NPN NO; NPN NC PNP NO; PNP NC	NPN NO/NC PNP NO/NC	/	NPN NO/NC PNP NO/NC
DC 4 Wires	/	/	/	/	RS485
Output	DC 2 Wires	/	/	/	/
	AC 2 Wires	/	/	/	/
	AC/DC 5 Wires	/	/	/	/
Supply voltage	10...30 VDC	10...30 VDC	10...30 VDC	10...30 VDC	10...30 VDC
Response time	DC: < 0.5ms	DC: < 1ms	DC: < 0.5ms	35ms	35ms
Ambient temperature	-20°C...55°C	-20°C...55°C	-25°C...55°C	-20...55°C	-20...55°C
Protection degree	IP65	IP65	IP67	IP67	IP67
Housing material	ABS	PC+PBT	PC+ABS	PC+ABS	PC+ABS
Connection	Cable, M8 Trunk line type	Cable	Cable M8 Connector	M8 Connector 2m PVC Cable	0.5m PVC Cable
Certification	CE UK EAC	CE UK EAC	CE UK EAC	—	—

Mark sensors



Shell code	SPM-TNR-WB	SPM-TNR-RGB	
Sensing distance	10±2mm	18...28mm	
Response time	1ms	<200µs	
Output	NPN NO/NC PNP NO/NC	NPN/PNP	
Supply voltage	12...24 VDC	24VDC±10% Ripple P-P < 10%	
Light source	Red light/green light, White light/blue light	Composite LED:Red/Green/Blue (Light source wavelength: 640nm/ 525nm/470nm)	
Withstanding voltage	1000V/AC 50/60Hz 60s	1000V/AC 50/60Hz 60s	
Insulation resistance	≥50MΩ(500VDC)	≥50MΩ(500VDC)	
Anti-vibration	10...50Hz,repeat-amplitude;1.5mm, (2 hours each for x,y,z direction)	10...50Hz,repeat-amplitude;1.5mm, (2 hours each for x,y,z direction)	
Ambient temperature	-25°C...55°C	-10...55°C (No frost, No condensation)	
Protection degree	IP65	IP65	
Housing material	PBT	PBT	
Connection	Cable	Cable	

Optical fiber sensors



Shell code	FD1	FD2	FD3
Sensing distance	Depand on fiber type	Depand on fiber type	Depand on fiber type
Response time	< 1ms	< 200µs (FINE) < 300µs (TURBO) < 550µs (SUPER)	50µs
Output	NPN+PNP NO/NC	NPN NO/NC PNP NO/NC	NPN PNP
Supply voltage	10...30 VDC	12...24 VDC	12...24 VDC
Illumination intensity	Incandescent lamp:intensity of illumination 3,000lux		
Withstanding voltage	AC1,000V 1 minute 50/60Hz		
Insulation resistance	>50MΩ,base on DC500V megger	>50MΩ,base on DC500V megger	>50MΩ,base on DC500V megger
Anti-vibration	10...55Hz,amplitude;1mm, (2 hours each for x,y,z direction)	10...55Hz,amplitude;1mm, (2 hours each for x,y,z direction)	10...55Hz,amplitude;1mm, (2 hours each for x,y,z direction)
Anti-concussion	Acceleration:500m/s ² (approx:30G) 3 times each for x,y and z direction	Acceleration:500m/s ² (approx:30G) 3 times each for x,y and z direction	Acceleration:500m/s ² (approx:30G) 3 times each for x,y and z direction
Ambient temperature	0°C...55°C (dewed or iced forbidden)	0°C...55°C (dewed or iced forbidden)	-20...55°C(No freezing)
Ambient humidity	35...85%RH		
Protection degree	IP54		
Housing material	PC+ABS		PC
Connection	Cable		

Optical fiber PFR series



Shell code	PFR-610	PFRC-610	PFRD-410	PFRC-410	PFRD-310	PFRC-310
Dimensions	M6	M6	M4	M4	M3	M3
Min bending radius	R25	R25	R15	R15	R15	R15
Sensing distance (mm)	FD1 Fiber optic amplifier	100	90	60	40	40
	FD2 Fiber optic amplifier	FINE:110 TURBO:190 SUPER:290	FINE:80 TURBO:170 SUPER:280	FINE:40 TURBO:90 SUPER:240	FINE:40 TURBO:70 SUPER:160	FINE:40 TURBO:70 SUPER:120
Min detected target (mm)	φ 0.2	φ 0.1	φ 0.1	φ 0.1	φ 0.1	φ 0.05

Optical fiber PFT series



Shell code	PFT-610	PFT-410	PFT-310	
Dimensions	M6	M4	M3	
Min bending radius	R25	R25	R2	
Sensing distance (mm)	FD1 Fiber optic amplifier	280mm	250mm	200mm
	FD2 Fiber optic amplifier	FINE:300 TURBO:500 SUPER:800	FINE:300 TURBO:500 SUPER:800	FINE:200 TURBO:400 SUPER:700
Min detected target (mm)	φ0.5	φ0.5	φ0.5	

Optical fiber PFT series



Shell code	PFT-R01	PFT-R02	PFT-S01	
Dimensions	Detection area 2×11	Detection area 3×40	—	
Min bending radius	R2	R2	R5	
Sensing distance (mm) FD3 Fiber optic amplifier	700...1200mm	1400...2000mm	1...25mm	

Optical fiber PFR/T-V series



Shell code	PFR-620-V	PFR-420-V	PFT-420-V	PFT-620-V
Dimensions	M6	M4	M4	M6
Min bending radius	R2	R2	R2	R2
Sensing distance (mm)	15/30/45mm	35/110/200mm	150/500/2000mm	150/500/2000mm

Color sensors



Shell code	Amplifier CPES-TxB
Response time	200µS (HIGH SPEED) /1ms (FINE) /4ms (TURBO) /8ms (SUPER)
Control output	NPN(PNP)Open collector X4 channel, max 40VDC(30VDC),1 output reaches 100mA,A total of 4 outputs reach 200mA,residual voltage:1V max
Output	NPN、PN
Supply voltage	24VDC, Ripple(P-P): <10%
Consumption current	Normal mode: 1.5W(≤62.5mA),Ecomode: 1W(≤42mA)
Timer function	Timer OFF/OFF-delay/ON-delay/single trigger, timer time is adjustable from 1 to 1,000ms (for each domain separately)
Ambient temperature	-10...55°C(No condensation)
Circuit protection	Short-circuit protection, Reverse polarity protection, Zener protection
Vibration resistance	10...55Hz, dual amplitude 1.5mm(2 hours each in X, Y, Z directions)

Detection head CPES-C09	
Examination range	11...20mm
Min spot diameter	1mm@16mm
Minimum bending radius	R25mm
Light source	Composite LED:Red/Green/Blue(Lightsource wave length:665nm/520nm/465nm)
Ambient luminosity	Incandescent: maximum1,000lux; Daylight: maximum20,000lux
Protection degree	IP40
Housing material	Body: PC; Lens cover: Polyarylate
Connection	2m PVC Cable

Digital laser distance sensors



Shell code		PDA	
Item code		Standard type	High precision type
Series code	RS...485	PDA-CC10DGR	PDA-CC10DGRM
	4...20mA	PDA-CC10TGI	PDA-CC10TGIM
Light source		Red Laser (650nm)	
Laser class		Class 2	
Spot diameter		1mm*3mm@100mm	
Measuring range		30...100mm	
Linear accuracy①②		RS-485: ±0.3%F.S. 4...20mA: ±0.4%F.S.	RS-485/4...20mA: ±0.1%F.S.
Repeated accuracy①②③		10μm@30mm; 30μm@50mm; 100μm@100mm	
Resolution		5μm@30mm; 50μm@100mm	
Supply voltage		RS-485:10...30VDC 4...20mA:12...24VDC	
Voltage drop		<2.5V	
Power consumption		≤700mW	
Load current		200mA	
Circuit protection④		Short circuit, reverse polarity, overload protection	
Output		RS-485(Support Modbus protocol);4...20mA(Load resistance < 390Ω)	
Integrated function⑤		Slave address,Port rate setting;Product self-check;Output setting;Analog map settings; Average setting;Parameter query;Single point teach;window teach;Window Teach-in setting	
Indicator		Power indicator: GreenLED; Action indicator: YellowLED; Alarm indicator: YellowLED	
Ambient temperature		-10°C...50°C	
Temperature drift		±0.02%F.S./°C	
Response time		2ms/16ms/40ms(Configurable)	
Ambient humidity		35...85%RH(No condensation)	
Anti-ambient light		Incandescent light: < 3,000lux	
Impulse withsand		500m/s ² (Approximate 50G),3 times each in X, Y, Z direction	
Vibration resistance		10...55Hz Double amplitude 1mm, 2H each in X, Y, Z directions	
Protection degree		IP67	
Material		Housing: Aluminum; Lens cover: PMMA; Display panel: PC	
Dimension		65*51*23mm	
Connection		2m 5-pin/4-pin PVC cable(5-pin: RS...485 output; 4-pin: analog output)	

Remark: ①Test conditions: standard data at (23.5)°C; supply voltage 24VDC; 30 minutes' warmup before test; sampling period 2ms; average sampling times 100; standard sensing object 90% white card.

②The statistical data follows the 3σ criteria

③Repeat accuracy: 23 ± 5 °C environment, 90% reflectivity white card, 100 test data results;

④Protection circuit only for switch output.

⑤Slave address, baud rate setting only for RS-485 series.

⑥Product operation steps and precautions in "User manual".

Digital laser distance sensors



Shell code		PDA	
Item code		Standard type	High precision type
Series code	RS...485	PDA-CC50DGR	PDA-CC50DGRM
	4...20mA	PDA-CC50TGI	PDA-CC50TGIM
Light source		Red Laser (650nm)	
Laser class		Class 2	
Spot diameter		Φ2.5mm@500mm	
Measuring range		80...500mm	
Linear accuracy①②		RS-485: ±0.3%F.S. 4...20mA: ±0.4%F.S.	RS-485/4...20mA: ±0.15%F.S. (80...250mm) ±0.3%F.S. (250...500mm)
Repeated accuracy①②③		30μm@80mm; 250μm@250mm; 1000μm@500mm	
Resolution		15μm@80mm; 500μm@500mm	
Supply voltage		RS-485:10...30VDC; 4...20mA:12...24VDC	
Voltage drop		<2.5V	
Power consumption		≤700mW	
Load current		200mA	
Circuit protection④		Short circuit, reverse polarity, overload protection	
Output		RS-485(Support Modbus protocol);4...20mA(Load resistance < 390Ω)	
Integrated function⑤		Slave address,Port rate setting;Product self-check;Output setting;Analog map settings; Average setting;Parameter query;Single point teach;window teach;Window Teach-in setting	
Indicator		Power indicator: GreenLED; Action indicator: YellowLED; Alarm indicator: YellowLED	
Ambient temperature		-10°C...50°C	
Temperature drift		±0.02%F.S./°C	
Response time		2ms/16ms/40ms(Configurable)	
Ambient humidity		35...85%RH(No condensation)	
Anti-ambient light		Incandescent light: < 3,000lux	
Impulse withstand		500m/s²(Approximate 50G),3 times each in X, Y, Z direction	
Vibration resistance		10...55Hz Double amplitude 1mm, 2H each in X, Y, Z directions	
Protection degree		IP67	
Material		Housing: Aluminum; Lens cover: PMMA; Display panel: PC	
Dimension		65*51*23mm	
Connection		2m 5-pin/4-pin PVC cable(5-pin: RS...485 output; 4-pin: analog output)	

Remark: ①Test conditions: standard data at (23.5)°C; supply voltage 24VDC; 30 minutes' warmup before test; sampling period 2ms; average sampling times 100; standard sensing object 90% white card.
 ②The statistical data follows the 3σ criteria
 ③Repeat accuracy: 23 ± 5 °C environment, 90% reflectivity white card, 100 test data results;
 ④Protection circuit only for switch output.
 ⑤Slave address, baud rate setting only for RS-485 series.
 ⑥Product operation steps and precautions in "User manual".

Digital laser distance sensors



Shell code		PDA	
Item code		Standard type	High precision type
Series code	RS...485	PDA-CC100DGR	PDA-CC100DGRM
	4...20mA	PDA-CC100TGI	PDA-CC100TGIM
Light source		Red Laser (650nm)	
Laser class		Class 2	
Spot diameter		Φ3mm@1000mm	
Measuring range		150...1000mm	
Linear accuracy①②		RS-485/4...20mA: ±0.6%F.S.	RS-485/4...20mA: ±0.3%F.S. (150...450mm) ±0.6%F.S. (450...1000mm)
Repeated accuracy①②③		100μm@150mm; 520μm@500mm; 4000μm@1000mm	
Resolution		50μm@150mm; 2000μm@1000mm	
Supply voltage		RS-485:10...30VDC; 4...20mA:12...24VDC	
Voltage drop		<2.5V	
Power consumption		≤700mW	
Load current		200mA	
Circuit protection④		Short circuit, reverse polarity, overload protection	
Output		RS-485(Support Modbus protocol);4...20mA(Load resistance < 390Ω)	
Integrated function⑤		Slave address,Port rate setting;Product self-check;Output setting;Analog map settings; Average setting;Parameter query;Single point teach;window teach;Window Teach-in setting	
Indicator		Power indicator: GreenLED; Action indicator: YellowLED; Alarm indicator: YellowLED	
Ambient temperature		-10°C...50°C	
Temperature drift		±0.02%F.S./°C	
Response time		2ms/16ms/40ms(Configurable)	
Ambient humidity		35...85%RH(No condensation)	
Anti-ambient light		Incandescent light: < 3,000lux	
Impulse withsand		500m/s²(Approximate 50G),3 times each in X, Y, Z direction	
Vibration resistance		10...55Hz Double amplitude 1mm, 2H each in X, Y, Z directions	
Protection degree		IP67	
Material		Housing: Aluminum; Lens cover: PMMA; Display panel: PC	
Dimension		65*51*23mm	
Connection		2m 5-pin/4-pin PVC cable(5-pin: RS...485 output; 4-pin: analog output)	

Remark: ①Test conditions: standard data at (23.5)°C; supply voltage 24VDC; 30 minutes' warmup before test; sampling period 2ms; average sampling times 100; standard sensing object 90% white card.

②The statistical data follows the 3σ criteria

③Repeat accuracy: 23 ± 5 °C environment, 90% reflectivity white card, 100 test data results;

④Protection circuit only for switch output.

⑤Slave address, baud rate setting only for RS-485 series.

⑥Product operation steps and precautions in "User manual".

Digital laser distance sensors



Shell code		PDB
Series code	RS...485	PDB-CM8DGR
	4...20mA	PDB-CM8TGI
	0...10V	PDB-CM8TGU
Measuring range	0.2...8m ^①	
Light source	Infrared laser(850nm)	
Laser class	Class 3	
Spot diameter	90*90mm(at 5mmeter)	
Working principle	TOF	
Repeated accuracy	±1%F.S.	
Linear accuracy ^①	±1%F.S.	
Resolution	1mm	
Supply voltage	RS-485:10...30VDC;4...20mA/0...10V:12...24VDC	
Voltage drop	<2.5V	
Consumption Power	≤700mW	
Load current	50mA	
Circuit protection	Short circuit, reverse polarity	
Impulse frequency	10MHZ	
Testing frequency	100HZ	
Impulse duration	50ns	
Average optical power	20mW	
Output	Output 1:Digital value:RS-485(Support ModBus protocol); Analog:4...20mA(Load resistance<300Ω),Analog:0...10V(Load resistance>5K) Output 2:Switch value:PUSH-PULL/NPN/PNP,NO/NC Settable	
Integrated function	Button to lock; button to unlock; action point setting;Output setting; single point teach; Window teach mode setting; factory date reset;Slave address&Port rate setting(only for RS-485)	
Indicator	Power indicator: Green LED;Action indicator: Yellow LED, Yellow LED	
Ambient temperature	-10°C...50°C	
Anti-ambient light	<20,000lux	
Impulse withstand	500m/s ² (Approximate 50G),3 times each in X, Y,Z direction	
Vibration resistance	10...55Hz Double amplitude1mm, 2H each in X, Y, Z directions	
Protection degree	IP67	
Material	Housing:ABS;Lens cover:PMMA	
Dimension	65*51*23mm	
Connection	RS-485:2m 5pins PVC cable;4...20mA:2m 4pins PVC cable;0...10V:2m 4pins PVC cable	

Note: ① Detection object is 90% white card

Laser distance sensors



Shell code		PDB
Series code	RS...485	PDB-CC50DGR
	4...20mA	PDB-CC50TGI
Light source	Red Laser (650nm)	
Laser class	Class 2	
Spot diameter	Φ2.5mm@500mm	
Measuring range	80...500mm	
Linear accuracy ^{①②}	RS-485: ±0.3%F.S. 4...20mA: ±0.4%F.S.	
Repeated accuracy ^{①②③}	30μm@80mm; 250μm@250mm; 1000μm@500mm	
Resolution	15μm@80mm; 500μm@500mm	
Supply voltage	RS-485:10...30VDC; 4...20mA:12...24VDC	
Voltage drop	<2.5V	
Power consumption	≤700mW	
Load current	200mA	
Circuit protection ^④	Short circuit, reverse polarity, overload protection	
Output	RS-485(Support Modbus protocol);4...20mA(Load resistance < 390Ω)	
Integrated function ^⑤	Slave address,Port rate setting;Product self-check;Output setting; Average setting;Parameter query;Single point teach;window teach;Window Teach-in setting	
Indicator	Power indicator: GreenLED; Action indicator: YellowLED; Alarm indicator: YellowLED	
Ambient temperature	-10°C...50°C	
Temperature drift	±0.02%F.S./°C	
Response time	2ms/16ms/40ms(Configurable)	
Ambient humidity	35...85%RH(No condensation)	
Anti-ambient light	Incandescent light: < 3,000lux	
Impulse withsand	500m/s ² (Approximate 50G),3 times each in X, Y, Z direction	
Vibration resistance	10...55Hz Double amplitude 1mm, 2H each in X, Y, Z directions	
Protection degree	IP67	
Material	Housing:ABS;Lens cover:PMMA	
Dimension	65*51*23mm	
Connection	RS...485:2m 5-pin PVCcable; 4...20mA:2m 4-pin PVC cable	

Remark: ①Test conditions: standard data at (23.5)°C; supply voltage 24VDC; 30 minutes' warmup before test; sampling period 2ms; average sampling times 100; standard sensing object 90% white card.

②The statistical data follows the 3σ criteria

③Repeat accuracy: 23 ± 5 °C environment, 90% reflectivity white card, 100 test data results;

④Protection circuit only for switch output.

⑤Slave address, baud rate setting only for RS-485 series.

⑥Product operation steps and precautions in "User manual".

Digital laser displacement sensors



Shell code		PDA	
Item code		Standard type	High precision type
Series code	RS...485	PDA-CR30DGR	PDA-CR30DGRM
	4...20mA	PDA-CR30TGI	PDA-CR30TGIM
Measuring center distance		30mm	
Measuring range		±5mm	
Light source		Red Laser (650nm)	
Laser class		Class 2	
Spot diameter		Φ0.5mm@30mm	
Linear accuracy ^{①②}		RS-485: ±0.3%F.S.; 4...20mA: ±0.4%F.S.	RS-485/4...20mA: ±0.1%F.S.
Repeated accuracy ^{①②③}		5μm	
Resolution		2.5μm@30mm	
Supply voltage		RS-485:10...30VDC; 4...20mA:12...24VDC	
Voltage drop		<2.5V	
Power consumption		≤700mW	
Load current		200mA	
Circuit protection ^④		Short circuit, reverse polarity, overload protection	
Output		RS-485(Support Modbus protocol);4...20mA(Load resistance < 390Ω)	
Integrated function ^⑤		Slave address,Port rate setting;Zero setting;Product self-check;Output setting;Analog map settings; Average setting;Parameter query;Single point teach;window teach;Window Teach-in setting	
Indicator		Power indicator: GreenLED; Action indicator: YellowLED; Alarm indicator: YellowLED	
Ambient temperature		-10°C...50°C	
Temperature drift		±0.08%F.S./°C	
Response time		2ms/16ms/40ms(Configurable)	
Ambient humidity		35...85%RH(No condensation)	
Anti-ambient light		Incandescent light: < 3,000lux	
Impulse withsand		500m/s ² (Approximate 50G),3 times each in X, Y, Z direction	
Vibration resistance		10...55Hz Double amplitude 1mm, 2H each in X, Y, Z directions	
Protection degree		IP67	
Material		Housing: Aluminum; Lens cover: PMMA; Display panel: PC	
Dimension		65*51*23mm	
Connection		2m 5-pin/4-pin PVC cable(5-pin: RS...485 output; 4-pin: analog output)	

Remark: ①Test conditions: standard data at (23.5)°C; supply voltage 24VDC; 30 minutes' warmup before test; sampling period 2ms; average sampling times 100; standard sensing object 90% white card.

②The statistical data follows the 3σ criteria

③Repeat accuracy: 23 ± 5 °C environment, 90% reflectivity white card, 100 test data results;

④Protection circuit only for switch output.

⑤Slave address, baud rate setting only for RS-485 series.

⑥Product operation steps and precautions in "User manual".

Digital laser displacement sensors



Shell code		PDA	
Item code		Standard type	High precision type
Series code	RS...485	PDA-CR50DGR	PDA-CR50DGRM
	4...20mA	PDA-CR50TGI	PDA-CR50TGIM
Measuring center distance		50mm	
Measuring range		±15mm	
Light source		Red Laser (650nm)	
Laser class		Class 2	
Spot diameter		Φ0.5mm@50mm	
Linear accuracy①②		RS-485: ±0.3%F.S.; 4...20mA: ±0.4%F.S.	RS-485/4...20mA: ±0.1%F.S.
Repeated accuracy①②③		20μm	
Resolution		10μm@50mm	
Supply voltage		RS-485:10...30VDC; 4...20mA:12...24VDC	
Voltage drop		<2.5V	
Power consumption		≤700mW	
Load current		200mA	
Circuit protection④		Short circuit, reverse polarity, overload protection	
Output		RS-485(Support Modbus protocol);4..20mA(Load resistance < 390Ω)	
Integrated function⑤		Slave address,Port rate setting;Zero setting;Product self-check;Output setting;Analog map settings; Average setting;Parameter query;Single point teach;window teach;Window Teach-in setting	
Indicator		Power indicator: GreenLED; Action indicator: YellowLED; Alarm indicator: YellowLED	
Ambient temperature		-10°C...50°C	
Temperature drift		±0.02%F.S./°C	
Response time		2ms/16ms/40ms(Configurable)	
Ambient humidity		35...85%RH(No condensation)	
Anti-ambient light		Incandescent light: < 3,000lux	
Impulse withsand		500m/s²(Approximate 50G),3 times each in X, Y, Z direction	
Vibration resistance		10...55Hz Double amplitude 1mm, 2H each in X, Y, Z directions	
Protection degree		IP67	
Material		Housing: Aluminum; Lens cover: PMMA; Display panel: PC	
Dimension		65*51*23mm	
Connection		2m 5-pin/4-pin PVC cable(5-pin: RS...485 output; 4-pin: analog output)	

Remark: ①Test conditions: standard data at (23.5)°C; supply voltage 24VDC; 30 minutes' warmup before test; sampling period 2ms; average sampling times 100; standard sensing object 90% white card.

②The statistical data follows the 3σ criteria

③Repeat accuracy: 23 ± 5 °C environment, 90% reflectivity white card, 100 test data results;

④Protection circuit only for switch output.

⑤Slave address, baud rate setting only for RS-485 series.

⑥Product operation steps and precautions in "User manual".

Digital laser displacement sensors



Shell code		PDA	
Item code		Standard type	High precision type
Series code	RS...485	PDA-CR85DGR	PDA-CR85DGRM
	4...20mA	PDA-CR85TGI	PDA-CR85TGIM
Measuring center distance		85mm	
Measuring range		±25mm	
Light source		Red Laser (650nm)	
Laser class		Class 2	
Spot diameter		Φ0.5mm@85mm	
Linear accuracy①②		RS-485: ±0.3%F.S.; 4...20mA: ±0.4%F.S.	RS-485/4...20mA: ±0.1%F.S.
Repeated accuracy①②③		60μm	
Resolution		30μm@85mm	
Supply voltage		RS-485:10...30VDC; 4...20mA:12...24VDC	
Voltage drop		<2.5V	
Power consumption		≤700mW	
Load current		200mA	
Circuit protection④		Short circuit, reverse polarity, overload protection	
Output		RS-485(Support Modbus protocol);4...20mA(Load resistance < 390Ω)	
Integrated function⑤		Slave address,Port rate setting;Zero setting;Product self-check;Output setting;Analog map settings; Average setting;Parameter query;Single point teach;window teach;Window Teach-in setting	
Indicator		Power indicator: GreenLED; Action indicator: YellowLED; Alarm indicator: YellowLED	
Ambient temperature		-10°C...50°C	
Temperature drift		±0.04%F.S./°C	
Response time		2ms/16ms/40ms(Configurable)	
Ambient humidity		35...85%RH(No condensation)	
Anti-ambient light		Incandescent light: < 3,000lux	
Impulse withstand		500m/s²(Approximate 50G),3 times each in X, Y, Z direction	
Vibration resistance		10...55Hz Double amplitude 1mm, 2H each in X, Y, Z directions	
Protection degree		IP67	
Material		Housing: Aluminum; Lens cover: PMMA; Display panel: PC	
Dimension		65*51*23mm	
Connection		2m 5-pin/4-pin PVC cable(5-pin: RS...485 output; 4-pin: analog output)	

Remark: ①Test conditions: standard data at (23.5)°C; supply voltage 24VDC; 30 minutes' warmup before test; sampling period 2ms; average sampling times 100; standard sensing object 90% white card.

②The statistical data follows the 3σ criteria

③Repeat accuracy: 23 ± 5 °C environment, 90% reflectivity white card, 100 test data results;

④Protection circuit only for switch output.

⑤Slave address, baud rate setting only for RS-485 series.

⑥Product operation steps and precautions in "User manual".

Laser displacement sensors



Shell code		PDB
Item code	RS...485	PDB-CR50DGR
	4...20mA	PDB-CR50TGI
Measuring center distance	50mm	
Measuring range	±15mm	
Light source	Red Laser (650nm)	
Laser class	Class 2	
Spot diameter	Φ0.5mm@50mm	
Linear accuracy①②	RS-485: ±0.3%F.S.; 4...20mA: ±0.4%F.S.	
Repeated accuracy①②③	20μm	
Resolution	10μm@50mm	
Supply voltage	RS-485:10...30VDC; 4...20mA:12...24VDC	
Voltage drop	<2.5V	
Power consumption	≤700mW	
Load current	200mA	
Circuit protection④	Short circuit, reverse polarity, overload protection	
Output	RS-485(Support Modbus protocol); 4...20mA(Load resistance < 390Ω)	
Integrated function⑤	Slave address,Port rate setting;Zero setting;Product self-check;Output setting; Average setting;Parameter query;Single point teach;window teach;Window Teach-in setting	
Indicator	Power indicator: GreenLED; Action indicator: YellowLED; Alarm indicator: YellowLED	
Ambient temperature	-10°C...50°C	
Temperature drift	±0.02%F.S./°C	
Response time	2ms/16ms/40ms(Configurable)	
Ambient humidity	35...85%RH(No condensation)	
Anti-ambient light	Incandescent light: < 3,000lux	
Impulse withsand	500m/s²(Approximate 50G),3 times each in X, Y, Z direction	
Vibration resistance	10...55Hz Double amplitude 1mm, 2H each in X, Y, Z directions	
Protection degree	IP67	
Material	Housing:ABS;Lens cover:PMMA	
Dimension	65*51*23mm	
Connection	RS...485:2m 5-pin PVCcable; 4...20mA:2m 4-pin PVC cable	

Remark: ①Test conditions: standard data at (23.5)°C; supply voltage 24VDC; 30 minutes' warmup before test; sampling period 2ms; average sampling times 100; standard sensing object 90% white card.

②The statistical data follows the 3σ criteria

③Repeat accuracy: 23 ± 5 °C environment, 90% reflectivity white card, 100 test data results;

④Protection circuit only for switch output.

⑤Slave address, baud rate setting only for RS-485 series.

⑥Product operation steps and precautions in "User manual".

CCD laser diameter measurement



Shell code		PDM
Item code		PDM-TC50TGR
Detection range	Width mode:10mm;Edge mode:±5mm	
Installation distance	0...50cm	
Smallest detector	Φ1mm(Sensor head:500 mm)ⓐ	
Light source	Red semiconductor laser;Laser class:Class 1	
Light spot size	14*12mm	
Supply voltage	12...24VDC	
Voltage drop	<2.5V	
Linear accuracy	±0.28%F.S.	
Repeat accuracy	±10μm(Setting distance:100 mm) ⓐ; ±15μm(Setting distance:500 mm)ⓑ	
Dimension	Emitter:55*32*23mm;Receiver:55*32*23mm	
Temperature drift	±0.08%F.S./°C, (±8μm/°C)	
Indicator (emission)	Optical axis calibration indication:Green LED;power indicator:Green LED	
Indicator (receive)	Optical axis calibration indication: Green LED; Position indicator:Double strip LED(Yellow,Green)	
Anti ambient light	Incandescent light < 3,000lux	
Protection degree	IP50	
Ambient temperature	-10...45°C(No freezing)	
Environment humidity	35...85%RH(Non-condensing)	
Material	Housing:Aluminium	
Connection method	PVC cable	
		Controller
Supply voltage	12...24VDC	
Consumption current	≤900mA(Emitter and receiver)	
Display resolution	1 μm	
Display range	-99.999...99.999	
Display method	Double-digit 8-segment display; Upper, lower: Red, 6-digit	
Response time	2ms	
Output 1	NPN NC	
Output 2	RS485 Output	
Ambient temperature	-10...45°C(Non-condensing)	
Environment humidity	35...85%RH(Non-condensing)	
Housing	Plastic	
Installation	Guide rail installation	

Remark: ⓐWhen the installation distance is 100 mm, the light is blocked at a position 50 mm away from the receiver. The margin of error to the ideal straight line
 ⓑWhen the light is blocked by half in the middle of the installation distance. The number of averages is set to 16 and sampling is executed for 30 seconds

Thin Gas Pressure Sensor



Item code	DPG-10Tx-L
Rated pressure range	-100.0...100.0kPa
Set pressure range	-105.0...105.0kPa
Pressure resistance	500kPa
Test gas type	Air, non corrosive, non combustible
Output	NPN/PNP (open collector), 1-5V (analog output)
Supply voltage	15...30VDC
Consumption current	≤40mA (No load)
Max load current	200mA
Max supply voltage	30VDC
Internal voltage drop	≤1.5V
Control input	NPN: low level input (mechanical switch or electronic switch) Level voltage requirement: below 0.4Vdc, input time above 10ms PNP: high level input (mechanical switch or electronic switch) Level voltage requirement: 20-24VDC, input time above 10ms
Max current of solenoid valve drive	200mA@24VDC max.
Repetition accuracy	±0.2%F.S.±1 digit
Reaction time	≤2.5ms (Malfunction prevention function: 2.5ms, 20ms, 100ms, 500ms, 1000ms, 1999ms optional)
Short circuit protection	OUT switch : Yes; Vacuum solenoid valve (v-sol) / vacuum breaking solenoid valve (d-sol): No
Indicator	Three ½ Bit LED 7 segment display (red) (sampling rate: 5 times / s)
Indication accuracy	±0.6%F.S.±1 digit
Linearity	±2%F.S.
Action indicator	OUT:Green; V-Sol control input: Red (Vacuum)
Protection degree	IP40
Voltage resistance	1000VAC 1min
Insulation resistance	>50MΩ (500VDC)
Impact resistance	980m/s ² (100G)
Temperature characteristic	±2%F.S. based on 25°C (temperataure range 0...50°C)
Air inlet form	90° air inlet port
Cable specification	Oil resistant NBR/PVC drag chain cable

Light curtains



- Synchronous scanning ensures safety and reliability.
- Various protection heights optional.
- Multi resolution optional: 14mm, 20mm, 25mm, 30mm, 40mm.
- Protecting human body from being hurt by dangerous machines, such as folding shear machine, paper cutter and punching machine etc.

Naming rules

L **G** **20** **□-T** **08** **05** **T** **NA-F2** **□□□□**
1 **2** **3** **4 5** **6** **7** **8** **9 10** **11**

1. Type code

L: Area light curtains
 S: Safety light curtains
 M: Measuring light curtains

2. Shape

C: Shape code 38*38mm
 G: Shape code 26*26mm
 H: Shape code 47*36mm

3. Optic axis distance

E.g. 20:20mm

4. Beam type

N/A: Light curtain with parallel beams

5. Detect mode

T: Through beam reflection

6. Optic axis number

04: 4 Axes 08: 8 Axes
 24: 24 Axes

7. Sensing distance

02:2m; 03:3m

8. Supply

T:12...24VDC D:10...30VDC
 L:15...30VDC

9. Output status

N/A: Emitter
 U: Voltage output(0...10V)
 U1: Voltage output(0...5V)
 I: Current output(0...20mA)
 IU: Voltage+current output(0...10V,0...20mA)
 NO: Receiver NPN NO output
 NC: Receiver NPN NC output
 PO: Receiver PNP NO output
 PC: Receiver PNP NC output

AO: Receiver NPN+NPN NO output
 AC: Receiver NPN+NPN NC output
 BO: Receiver PNP+PNP NO output
 BC: Receiver PNP+PNP NC output

10. Connection

N/A: Cable:2m
 3M: Cable:3m
 E2: M12 Plug 4pin
 E3: M8 Plug 4pin
 E5: M12 Plug 4pin
 E8: M12 Plug 8pin
 F2: M12 Plug 4pin with cable

11. Special requirement

In 4 digits



Area light curtains

- Ultra long detection range.
- Various series and specifications optional, detection range from 120 to 1920mm.
- Products with self-check function, be able to detect internal exceptions.
- Strong intensity LED indicates operation status.

Axes quantity	8Axes	12Axes	16Axes	20Axes	24Axes	28Axes	32Axes
Emitter	LG20-T0805T-F2	LG20-T1205T-F2	LG20-T1605T-F2	LG20-T2005T-F2	LG20-T2405T-F2	LG20-T2805T-F2	LG20-T3205T-F2
NPN NO/NC	LG20-T0805TNA-F2	LG20-T1205TNA-F2	LG20-T1605TNA-F2	LG20-T2005TNA-F2	LG20-T2405TNA-F2	LG20-T2805TNA-F2	LG20-T3205TNA-F2
PNP NO/NC	LG20-T0805TPA-F2	LG20-T1205TPA-F2	LG20-T1605TPA-F2	LG20-T2005TPA-F2	LG20-T2405TPA-F2	LG20-T2805TPA-F2	LG20-T3205TPA-F2
Protection height	140mm	220mm	300mm	380mm	460mm	540mm	620mm
Response time	<10ms	<15ms	<20ms	<25ms	<30ms	<35ms	<40ms
Axes quantity	36Axes	40Axes	44Axes	48Axes			
Emitter	LG20-T3605T-F2	LG20-T4005T-F2	LG20-T4405T-F2	LG20-T4805T-F2			
NPN NO/NC	LG20-T3605TNA-F2	LG20-T4005TNA-F2	LG20-T4405TNA-F2	LG20-T4805TNA-F2			
PNP NO/NC	LG20-T3605TPA-F2	LG20-T4005TPA-F2	LG20-T4405TPA-F2	LG20-T4805TPA-F2			
Protection height	700mm	780mm	860mm	940mm			
Response time	<45ms	<50ms	<55ms	<60ms			
Detection width	0.5...5m						
Axis distance	20mm						
Sensing object	> Φ 30mm opaque object						
Power voltage	12...24 VDC \pm 10%						
Current consumption	Emitter: < 60mA(Current consumption has nothing to do with the number of axes) Receiver: < 45mA(8 axes, current consumption will increase 5mA when 8 axes increased)						
Light source	850nm Infrared (modulate)						
Circuit protection	Reverse polarity, short-circuit protection, overload protection						
Ambient temperature	-10°C...55°C(dewed or iced forbidden), storage: -10°C...60°C						
Ambient humidity	35...85%RH, storage:35...85%RH						
Intensity of illumination	Incandescent lamp: intensity of illumination 4,000lux						
Anti-vibration	10...55Hz,amplitude:1.2mm,2 hours each for x, y and z direction						
Anti-shocking	Acceleration:500m/s ² (approx:50G),3 times each for x, y and z direction						
Protection degree	IP65						
Housing material	Housing: AL; Light cover: PC; End cover: enhanced nylon						
Connection	18cm cable with M12 connector						
Accessory	5m Connection cable(QE12-N4F5, QE12-N3F5)						

Datasheets

Item code	A	B	H	L
LG20-T0805T/TxA-F2	20	20	140	180
LG20-T1205T/TxA-F2	20	20	220	260
LG20-T1605T/TxA-F2	20	20	300	340
LG20-T2005T/TxA-F2	20	20	380	420
LG20-T2405T/TxA-F2	20	20	460	500
LG20-T2805T/TxA-F2	20	20	540	580
LG20-T3205T/TxA-F2	20	20	620	660
LG20-T3605T/TxA-F2	20	20	700	740
LG20-T4005T/TxA-F2	20	20	780	820
LG20-T4405T/TxA-F2	20	20	860	900
LG20-T4805T/TxA-F2	20	20	940	980

H: Protection height, H=A* (N-1)
A: Axis distance, 20mm

L: Total height: L=H+40mm
N: Optic axis quantity

Dimensions

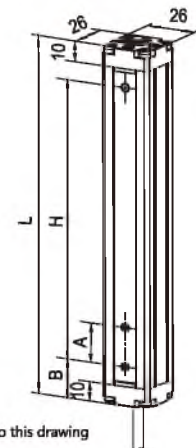

Note: Dimension of LG20, LG40 also refers to this drawing

Area light curtains

Axes quantity	4Axes	6Axes	8Axes	10Axes	12Axes	14Axes	16Axes
Emitter	LG40-T0405T-F2	LG40-T0605T-F2	LG40-T0805T-F2	LG40-T1005T-F2	LG40-T1205T-F2	LG40-T1405T-F2	LG40-T1605T-F2
NPN NO/NC	LG40-T0405TNA-F2	LG40-T0605TNA-F2	LG40-T0805TNA-F2	LG40-T1005TNA-F2	LG40-T1205TNA-F2	LG40-T1405TNA-F2	LG40-T1605TNA-F2
PNP NO/NC	LG40-T0405TPA-F2	LG40-T0605TPA-F2	LG40-T0805TPA-F2	LG40-T1005TPA-F2	LG40-T1205TPA-F2	LG40-T1405TPA-F2	LG40-T1605TPA-F2
Protection height	120mm	200mm	280mm	360mm	440mm	520mm	600mm
Response time	< 5ms	< 10ms	< 15ms	< 20ms	< 25ms	< 30ms	< 35ms
Axes quantity	18Axes	20Axes	22Axes	24Axes	26Axes	28Axes	30Axes
Emitter	LG40-T1805T-F2	LG40-T2005T-F2	LG40-T2205T-F2	LG40-T2405T-F2	LG40-T2605T-F2	LG40-T2805T-F2	LG40-T3005T-F2
NPN NO/NC	LG40-T1805TNA-F2	LG40-T2005TNA-F2	LG40-T2205TNA-F2	LG40-T2405TNA-F2	LG40-T2605TNA-F2	LG40-T2805TNA-F2	LG40-T3005TNA-F2
PNP NO/NC	LG40-T1805TPA-F2	LG40-T2005TPA-F2	LG40-T2205TPA-F2	LG40-T2405TPA-F2	LG40-T2605TPA-F2	LG40-T2805TPA-F2	LG40-T3005TPA-F2
Protection height	680mm	760mm	840mm	920mm	1000mm	1080mm	1160mm
Response time	< 40ms	< 45ms	< 50ms	< 55ms	< 60ms	< 65ms	< 70ms
Axes quantity	32Axes	34Axes	36Axes	38Axes	40Axes	42Axes	44Axes
Emitter	LG40-T3205T-F2	LG40-T3405T-F2	LG40-T3605T-F2	LG40-T3805T-F2	LG40-T4005T-F2	LG40-T4205T-F2	LG40-T4405T-F2
NPN NO/NC	LG40-T3205TNA-F2	LG40-T3405TNA-F2	LG40-T3605TNA-F2	LG40-T3805TNA-F2	LG40-T4005TNA-F2	LG40-T4205TNA-F2	LG40-T4405TNA-F2
PNP NO/NC	LG40-T3205TPA-F2	LG40-T3405TPA-F2	LG40-T3605TPA-F2	LG40-T3805TPA-F2	LG40-T4005TPA-F2	LG40-T4205TPA-F2	LG40-T4405TPA-F2
Protection height	1240mm	1320mm	1400mm	1480mm	1560mm	1640mm	1720mm
Response time	< 75ms	< 80ms	< 85ms	< 90ms	< 95ms	< 100ms	< 105ms
Axes quantity	46Axes	48Axes					
Emitter	LG40-T4605T-F2	LG40-T4805T-F2					
NPN NO/NC	LG40-T4605TNA-F2	LG40-T4805TNA-F2					
PNP NO/NC	LG40-T4605TPA-F2	LG40-T4805TPA-F2					
Protection height	1840mm	1920mm					
Response time	< 110ms	< 115ms					
Detection width	0.5...5m						
Axis distance	40mm						
Sensing object	>Φ60mm opaque object						
Power voltage	12...24 VDC±10%						
Current consumption	Emitter: < 60mA(Current consumption has nothing to do with the number of axes) Receiver: < 45mA(8 axes, current consumption will increase 5mA when 8 axes increased)						
Light source	850nm Infrared (modulate)						
Circuit protection	Reverse polarity, short-circuit protection, overload protection						
Ambient temperature	-10°C...55°C(dewed or iced forbidden), storage: -10°C...60°C						
Ambient humidity	35...85%RH, storage:35...85%RH						
Intensity of illumination	Incandescent lamp: intensity of illumination 4,000lux						
Anti-vibration	10...55Hz,amplitude:1.2mm,2 hours each for x, y and z direction						
Anti-shocking	Acceleration:500m/s²(approx:50G),3 times each for x, y and z direction						
Protection degree	IP65						
Housing material	Housing: AL; Light cover: PC; End cover: enhanced nylon						
Connection	18cm cable with M12 connector						
Accessory	5m Connection cable(QE12-N4F5, QE12-N3F5)						

Datasheets

Item code	A	B	H	L	Item code	A	B	H	L
LG40-T0405T/TxA-F2	40	20	120	160	LG40-T2805T/TxA-F2	40	20	1080	1120
LG40-T0605T/TxA-F2	40	20	200	240	LG40-T3005T/TxA-F2	40	20	1160	1200
LG40-T0805T/TxA-F2	40	20	280	320	LG40-T3205T/TxA-F2	40	20	1240	1280
LG40-T1005T/TxA-F2	40	20	360	400	LG40-T3405T/TxA-F2	40	20	1320	1360
LG40-T1205T/TxA-F2	40	20	440	480	LG40-T3605T/TxA-F2	40	20	1400	1440
LG40-T1405T/TxA-F2	40	20	520	560	LG40-T3805T/TxA-F2	40	20	1480	1520
LG40-T1605T/TxA-F2	40	20	600	640	LG40-T4005T/TxA-F2	40	20	1560	1600
LG40-T1805T/TxA-F2	40	20	680	720	LG40-T4205T/TxA-F2	40	20	1640	1680
LG40-T2005T/TxA-F2	40	20	760	800	LG40-T4405T/TxA-F2	40	20	1720	1760
LG40-T2205T/TxA-F2	40	20	840	880	LG40-T4605T/TxA-F2	40	20	1800	1840
LG40-T2405T/TxA-F2	40	20	920	960	LG40-T4805T/TxA-F2	40	20	1880	1920
LG40-T2605T/TxA-F2	40	20	1000	1040					

H: Protection height, H=A* (N-1) L: Total height: L=H+40mm A: Axis distance 40mm N: Optic axis quantity

Measuring light curtains



- RS485 synchronous scanning technology, strong anti interference function.
- Various detection height, from 300mm to 2220mm.
- Optic axis distance:20mm.
- Dual switch control with two-way switch value and RS485 output.
- Faul+alarm and fault diagnosis function.

Axes quantity	16Axes	32Axes	48Axes	64Axes
Emitter	MH20-T1605L-F2	MH20-T3205L-F2	MH20-T4805L-F2	MH20-T6405L-F2
Receiver	MH20-T1605LS1DA-F8	MH20-T3205LS1DA-F8	MH20-T4805LS1DA-F8	MH20-T6405LS1DA-F8
Protection height	300mm	620mm	940mm	1260mm
Response time	5ms	10ms	15ms	18ms
Axes quantity	80Axes	96Axes	112Axes	
Emitter	MH20-T8005L-F2	MH20-T9605L-F2	MH20-T11205L-F2	
Receiver	MH20-T8005LS1DA-F8	MH20-T9605LS1DA-F8	MH20-T11205LS1DA-F8	
Protection height	1580mm	1900mm	2220mm	
Response time	19ms	20ms	24ms	
Detection width	0...5m			
Axis distance	20mm			
Sensing object	>Φ30mm opaque object			
Output	Two output NPN/PNP、NC/NO+RS485			
Supply voltage	15...30 VDC			
Current consumption	< 130mA@16axes@30VDC			
Light source	Infrared LED(modulate)			
Circuit protection	Short circuit, zener, surge protection, reverse polarity protection			
Ambient temperature	-25°C...55°C(dewed or iced forbidden), storage: -30°C...75°C			
Ambient humidity	35...95%RH			
Intensity of illumination	Incandescent lamp: intensity of illumination > 5,000lux			
Anti-vibration	10...55Hz, amplitude: 0.5mm, 2 hours each for x, y and z direction			
Anti-shocking	Acceleration: 300m/s ² (approx:30G), 3 times each for x, y and z direction			
Protection	IP67			
Housing material	Housing: AL; Light cover: PC; End cover: AL			
Connection	Emitter: M12 connector 4 pin, receiver: M12 connector 8 pin			
Accessory	Shielding wire(8 pin) 1 pc (standard length 3m), Shielding wire(4 pin) 1 pc (standard length 15m)			

Datasheets

Item code	A	B	H	L
MH20-T1605LS1DA-F8	20	70.2	300	363
MH20-T3205LS1DA-F8	20	70.2	620	683
MH20-T4805LS1DA-F8	20	70.2	940	1003
MH20-T6405LS1DA-F8	20	70.2	1260	1323
MH20-T8005LS1DA-F8	20	70.2	1580	1643
MH20-T9605LS1DA-F8	20	70.2	1900	1963
MH20-T11205LS1DA-F8	20	70.2	2220	2283

H:Protection height, H=20*(N-1)mm L:Total length:L=H+63mm
 N:Optic axis quantity

Dimensions

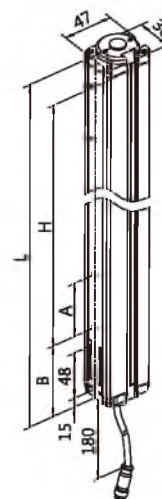

Measuring light curtains



- RS485 synchronous scanning technology, strong anti interference function.
- Various detection height, from 300mm to 2220mm.
- Optic axis distance:20mm.
- Dual switch control with two-way switch value and RS485 output.
- Faul+alarm and fault diagnosis function.

Axes quantity	8Axes	16Axes	24Axes	32Axes
Emitter	MH40-T0805L-F2	MH40-T1605L-F2	MH40-T2405L-F2	MH40-T3205L-F2
Receiver	MH40-T0805LS1DA-F8	MH40-T1605LS1DA-F8	MH40-T2405LS1DA-F8	MH40-T3205LS1DA-F8
Protection height	280mm	600mm	920mm	1260mm
Response time	5ms	10ms	15ms	18ms
Axes quantity	40Axes	48Axes	56Axes	
Emitter	MH40-T4005L-F2	MH40-T4805L-F2	MH40-T5605L-F2	
Receiver	MH40-T4005LS1DA-F8	MH40-T4805LS1DA-F8	MH40-T5605LS1DA-F8	
Protection height	1560mm	1880mm	2200mm	
Response time	19ms	20ms	24ms	
Detection width	0...5m			
Axis distance	40mm			
Sensing object	> Φ30mm opaque object			
Output	Two output NPN/PNP, NC/NO+RS485			
Supply voltage	15...30 VDC			
Current consumption	< 130mA@16axes@30VDC			
Light source	Infrared LED(modulate)			
Circuit protection	Short circuit, zener, surge protection, reverse polarity protection			
Ambient temperature	-25°C...55°C(dewed or iced forbidden), storage: -30°C...75°C			
Ambient humidity	35...95%RH			
Intensity of illumination	Incandescent lamp: intensity of illumination > 5,000lux			
Anti-vibration	10...55Hz, amplitude: 0.5mm, 2 hours each for x, y and z direction			
Anti-shocking	Acceleration: 300m/s ² (approx:30G), 3 times each for x, y and z direction			
Protection	IP67			
Housing material	Housing: AL; Light cover: PC; End cover: AL			
Connection	Emitter: M12 connector 4 pin, receiver: M12 connector 8 pin			
Accessory	Shielding wire(8 pin) 1 pc (standard length 3m), Shielding wire(4 pin) 1 pc (standard length 15m)			

Datasheets

Item code	A	B	H	L
MH40-T0805LS1DA-F8	40	70.2	280	363
MH40-T1605LS1DA-F8	40	70.2	600	683
MH40-T2405LS1DA-F8	40	70.2	920	1003
MH40-T3205LS1DA-F8	40	70.2	1240	1323
MH40-T4005LS1DA-F8	40	70.2	1560	1643
MH40-T4805LS1DA-F8	40	70.2	1880	1963
MH40-T5605LS1DA-F8	40	70.2	2200	2283

H:Protection height, H=20*(N-1)mm L:Total length:L=H+83mm
 N:Optic axis quantity

Dimensions

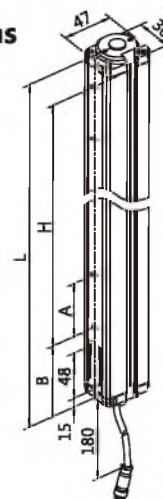

Naming rules



1. Type code

TW: Tension sensor

2. Shape code

- A: Housing 1
- B: Housing 2
- C: Housing 3
- C1: Housing 3 (With hooked yarn guide)
- D: Housing 4 (Type T)
- E: Housing 5
- F: Housing of Elevator Weighing Sensor
- G: Housing 6
-

3. Sensitive probe

- T: Ceramic sensing probe
- Y: Strain gauge sensing probe
- H: Hall sensing probe

4. Measurement range

- 101:0...100cN(T/Y)
- 301:0...300cN(T/Y)
- 402:0...4000cN(T/Y)
- 202:0...2000cN(T/Y)
-

5. Detect mode

- B:19...29VDC
- D:10...30VDC
- F:10...18VDC
- T:12...24VDC
- M:24VDC
-

6. Output

- A:0.1...2.5VDC
- B:0.1...5VDC
- C:0.5...6VDC
- D:0.5...4.5VDC
- E:0.1...4VDC
- F:2...6VDC
- N:NPN
- P:PNP
-

7. Connection

- E.g. 2m Cable
- A: 0.25m Shielded cable with 3 pins
- B: M12 3 pins connector
- C: M12 4 pins connector
- D: M12 5 pins connector
- E: 3 pins connector
- F: 2.54 socket with 5 pins
- G: Socket with 3 pins
- H: 3 pins plug with cable(2.0)
-

8. Special requirement

- In 4 digits

Tension sensor

Tension sensors are widely used to detect tension of yarn during operation in textile and chemical fiber industry. During spinning, the tension of yarn will be changed to weak voltage signal and will be amplified by filter circuit, amplifying circuit, linear compensation circuit and adjusting circuit. The amplified voltage signal will be linearly outputted with tension.

- Fast response, high sensitivity.
- Wide measuring tension range.
- Fine linearity and temperature feature.
- Less damage to material.
- Mainly used in textile industry.



Shell code	TWC	TWK
Supply voltage	10...30VDC	10...30VDC
Current consumption	<15mA	< 22mA
Non-linearity	<1%FS	< 2%FS
Tension range	0...300cN, 0...100cN	0...100cN, 0...300cN
Sensor	Ceramic strain gauge type	Hall sensor
Output	Voltage output: 0.5...6VDC	Voltage output: 0.3...2.3VDC
Connection	Terminal	Plug-in unit
Circuit protection	Reverse polarity protection	Reverse polarity protection, Surge protection
Ambient temperature	0...50°C(dewed or iced forbidden)	0...50°C(dewed or iced forbidden)
Housing material	Housing: zinc aluminum; Transmission: ceramics	Housing: zinc alloy; Transmission: ceramics

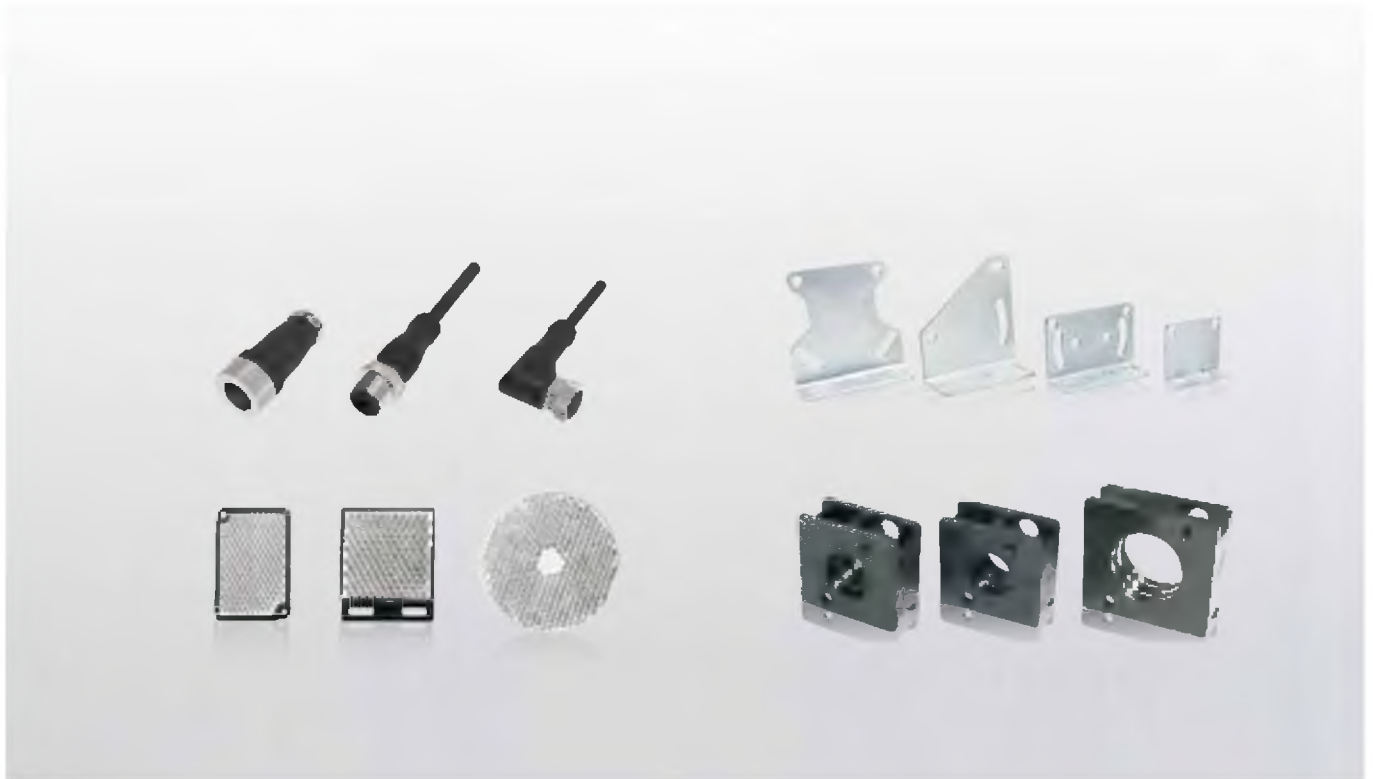

Sensor accessories



Connection cables & Distribution Box

Mounting brackets

Reflectors

Mounting clamps

Connection cable

Naming rules

Q E12 - N 3 G 5 P U - E12 N 3 F □□□□

1 2 3 4 5 6 7 8 9 10 11 12 13

1. Connector classification

C: Customized
Q: Standard

2. Connector specification

E8: M8 connector
E12: M12 connector

3. Thread type

N: Internal thread connection
W: External thread connection

4. Pin number

3: 3 pin
4: 4 pin
5: 5 pin
.....

5. Cable lead-out

F: 180° straight angle
G: 90° right angle

6. Cable length

N/A: Connector
02: 0.2m cable
2: 2m cable
5: 5m cable
10: 10m cable
.....

7. Connector classification

N/A: No LED, universal
P: With LED, PNP interface
N: With LED, NPN interface

8. Cable material

N/A: PVC
U: PUR

9. Connector specification

N/A: With cable directly
E8: With M8 connector
E12: With M12 connector
.....

10. Thread type

N/A: With cable directly
N: Internal thread connection
W: External thread connection

11. Pin number

N/A: With cable directly
3: 3 pins
4: 4 pins
5: 5 pins
.....

12. Cable lead-out

N/A: With cable directly
F: 180° straight angle
G: 90° right angle

13. Special code

In 4 digits

Model & Code

DB 12 08 04 - x - Mxx P

1 2 3 4 5 6 7

1. Product series

DB: Distribution box

2. Core wire

08: M8 Connector
12: M12 Connector

3. I/O channel number

04:4
06:6
08:8
10:10

4. I/O port

03:3
04:4
05:5

5. Cable material

0: No cable
1: PVC
2: PUR

6. Cable type

D: D-SUB
M: Plug connector M23
None: pre-wired cable
03: 3m Cable
05: 5m Cable
07: 7m Cable

7. LED indication

P: PNP
N: NPN

Connection cable (LED)



Shell code	QE12-N3Fx-x	QE12-N3Gx-x	QE12-N4Fx-x	QE12-N4Gx-x	
Specifications	M12*40	M12*42	M12*40	M12*42	
Operating voltage	30VDC Max	30VDC Max	30VDC Max	30VDC Max	
Nominal current	4A	4A	4A	4A	
Insulation resistance	100MΩ	100MΩ	100MΩ	100MΩ	
Output	NPN/PNP	NPN/PNP	NPN/PNP	NPN/PNP	
Temperature range	-30°C...90°C	-30°C...90°C	-30°C...90°C	-30°C...90°C	
Outer covering	PU	PU	PU	PU	
Bearing material	Nickel-copper alloy	Nickel-copper alloy	Nickel-copper alloy	Nickel-copper alloy	
Protection degree	IP67	IP67	IP67	IP67	
Material	PVC/PU	PVC/PU	PVC/PU	PVC/PU	
Diameter	Φ4.4	Φ4.4	Φ5.2	Φ5.2	
Core wire	3*0.34mm ² (0.2*11)	3*0.34mm ² (0.2*11)	4*0.34mm ² (0.2*11)	4*0.34mm ² (0.2*11)	
Length	2m/5m	2m/5m	2m/5m	2m/5m	

Connection cable



Shell code	QE8-NxFx	QE8-NxGx	QE8-WxFx	QE8-WxGx	QE12-NxFx
Specifications	M8*35.5	M8*21	M8*40.5	M8*21	M12*40
Operating voltage	60 VAC/DC	60 VAC/DC	60 VAC/DC	60 VAC/DC	250V AC/DC
Nominal current	4A	4A	4A	4A	4A
Insulation resistance	100MΩ	100MΩ	100MΩ	100MΩ	100MΩ
Temperature range	-30°C...90°C	-30°C...90°C	-30°C...90°C	-30°C...90°C	-30°C...90°C
Outer covering	PVC	PVC	PVC	PVC	PVC
Bearing material	Nickel-copper alloy	Nickel-copper alloy	Nickel-copper alloy	Nickel-copper alloy	Nickel-copper alloy
Protection degree	IP67	IP67	IP67	IP67	IP67
Material	PVC/PU	PVC/PU	PVC/PU	PVC/PU	PVC/PU
Diameter	Φ4.4	Φ4.4	Φ4.4	Φ4.4	Φ5.2
Core wire	3*0.25mm ² (0.1*32)/ 4*0.25mm ² (0.1*32)	3*0.25mm ² (0.1*32)/ 4*0.25mm ² (0.1*32)	3*0.25mm ² (0.1*32)/ 4*0.25mm ² (0.1*32)	3*0.25mm ² (0.1*32)/ 4*0.25mm ² (0.1*32)	3*0.34mm ² (0.2*11)/ 4*0.34mm ² (0.2*11)/ 5*0.34mm ² (0.2*11)
Length	2m/5m	2m/5m	2m/5m	2m/5m	2m/5m

Connection cable

Connectors



Shell code	QE12-NxGx	QE12-WxFx	QE12-WxGx	QE8-NxF	QE8-WxF
Specifications	M12*42	M12*42	M12*42	M8*40	M8*46.5
Operating voltage	250 VAC/DC	250 VAC/DC	250 VAC/DC	60 VAC/DC	60 VAC/DC
Nominal current	4A	4A	4A	4A	4A
Insulation resistance	100MΩ	100MΩ	100MΩ	100MΩ	100MΩ
Temperature range	-30°C...90°C	-30°C...90°C	-30°C...90°C	-40°C...85°C	-40°C...85°C
Outer covering	PVC	PVC	PVC	PVC	PVC
Bearing material	Nickel-copper alloy	Nickel-copper alloy	Nickel-copper alloy	Nickel-copper alloy	Nickel-copper alloy
Protection degree	IP67	IP67	IP67	IP67	IP67
Material	PVC/PU	PVC/PU	PVC/PU	/	/
Diameter	Φ5.2	Φ5.2	Φ5.2	4...5mm	4...5mm
Core wire	3*0.34mm ² (0.2*11) / 4*0.34mm ² (0.2*11) / 5*0.34mm ² (0.2*11)	3*0.34mm ² (0.2*11) / 4*0.34mm ² (0.2*11) / 5*0.34mm ² (0.2*11)	3*0.34mm ² (0.2*11) / 4*0.34mm ² (0.2*11) / 5*0.34mm ² (0.2*11)	3 pins/4 pins	3 pins/4 pins
Length	2m/5m	2m/5m	2m/5m	/	/

Connectors



Shell code	QE12-NxF	QE12-NxG	QE12-WxF	QE12-WxG	
Specifications	M12*48	M12*37.6	M12*56.7	M12*37.6	
Operating voltage	250 VAC/DC	250 VAC/DC	250V AC/DC	250 VAC/DC	
Nominal current	4A	4A	4A	4A	
Insulation resistance	100MΩ	100MΩ	100MΩ	100MΩ	
Temperature range	-40°C...85°C	-40°C...85°C	-40°C...85°C	-40°C...85°C	
Outer covering	PVC	PVC	PVC	PVC	
Bearing material	Nickel-copper alloy	Nickel-copper alloy	Nickel-copper alloy	Nickel-copper alloy	
Protection degree	IP67	IP67	IP67	IP67	
Material	/	/	/	/	
Diameter	4...6mm	4...6mm	4...6mm	4...6mm	
Core wire	4 pins/5 pins	4 pins/5 pins	4 pins/5 pins	4 pins/5 pins	
Length	/	/	/	/	

Distribution Box



Shell code	DB080403-x-xxx	DB080803-x-xxx	DB080803-x-Dxxx	
Specifications	90*45	98*45	152*54	
Operating voltage	10...30 VDC	10...30 VDC	10...30 VDC	
Nominal current	2A/Port, 8A/Total	2A/Port, 8A/Total	4A/Port, 10A/Total	
Insulation resistance	8mΩ MAX	8mΩ MAX	8mΩ MAX	
Temperature range	-20°C...80°C	-20°C...80°C	-20°C...80°C	
Output status	NPN/PNP	NPN/PNP	NPN/PNP	
Output way	NO	NO	NO	
Output indicate	Yellow LED	Yellow LED	Yellow LED	
Connection specification	M8 port 3-core	M8 port 3-core	M12 port 4-core	
Material	/	PVC	/	
Socket material	Carobronze/Gold plated	Carobronze/Gold plated	Carobronze/Gold plated	
Length	/	3m	/	

Distribution Box



Shell code	DB120804-x-xxx	DB120804-x-Mxxx	DB120805-x-xxx	DB120805-x-Mxxx
Specifications	90*45	98*45	152*54	152*54
Operating voltage	10...30 VDC	10...30 VDC	10...30 VDC	10...30 VDC
Nominal current	2A/Port, 8A/Total	2A/Port, 8A/Total	4A/Port, 10A/Total	4A/Port, 10A/Total
Insulation resistance	8mΩ MAX	8mΩ MAX	8mΩ MAX	8mΩ MAX
Temperature range	-20°C...80°C	-20°C...80°C	-20°C...80°C	-20°C...80°C
Output status	NPN/PNP	NPN/PNP	NPN/PNP	NPN/PNP
Output way	NO	NO	NO	NO
Output indicate	Yellow LED	Yellow LED	Yellow LED	Yellow LED
Connection specification	M8 port 3-core	M8 port 3-core	M12 port 4-core	M12 port 4-core
Material	/	PVC	/	PVC
Socket material	Carobronze/Gold plated	Carobronze/Gold plated	Carobronze/Gold plated	Carobronze/Gold plated
Length	/	3m	/	5m

ZJP-8 (PSE/PSR Mounting rack)

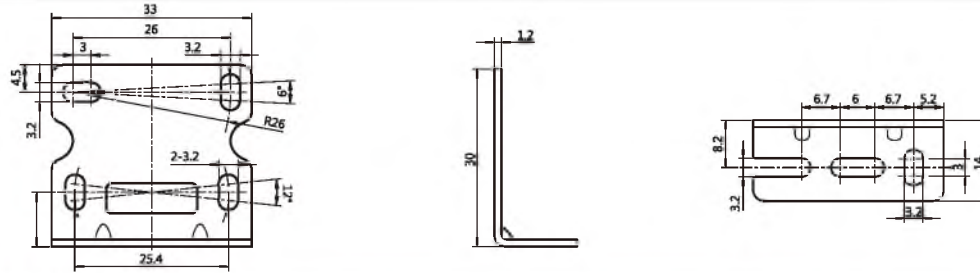

ZJP-9 (PSS/PSM Mounting rack)

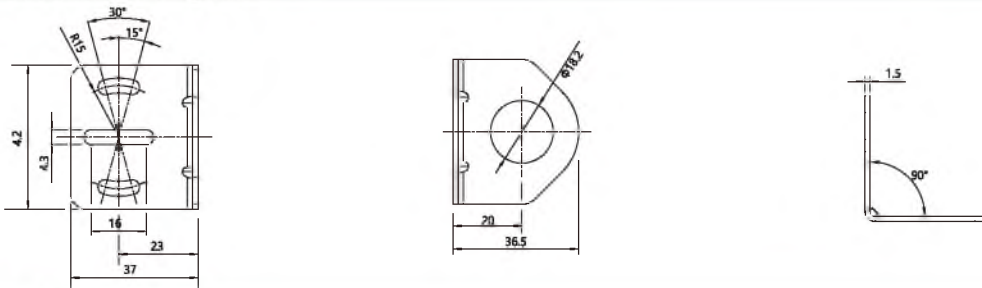

ZJP-10 (PSS Mounting rack)



ZJP-11 (PST Mounting rack)

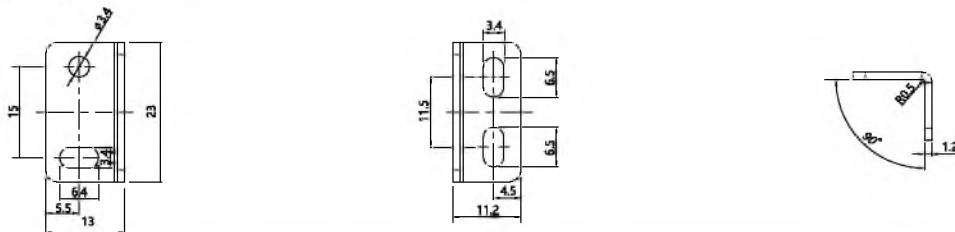

ZJP-12 (PST Mounting rack)

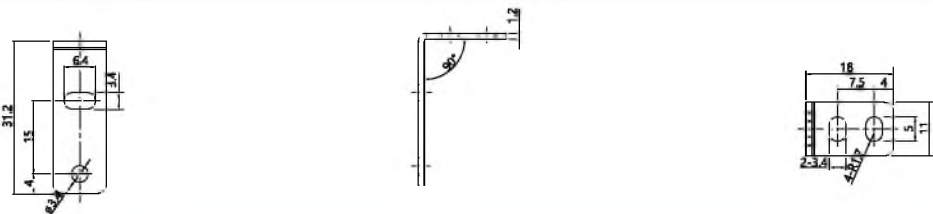

ZJP-13 (PST Mounting rack)

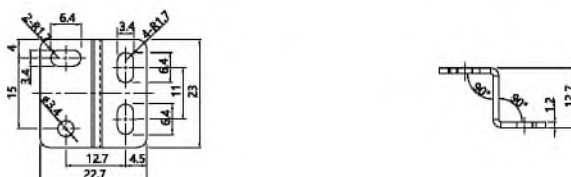

ZJP-14 (PSV Mounting rack)

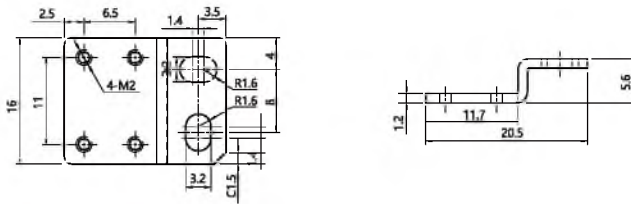

ZJP-15 (PDA Mounting rack)

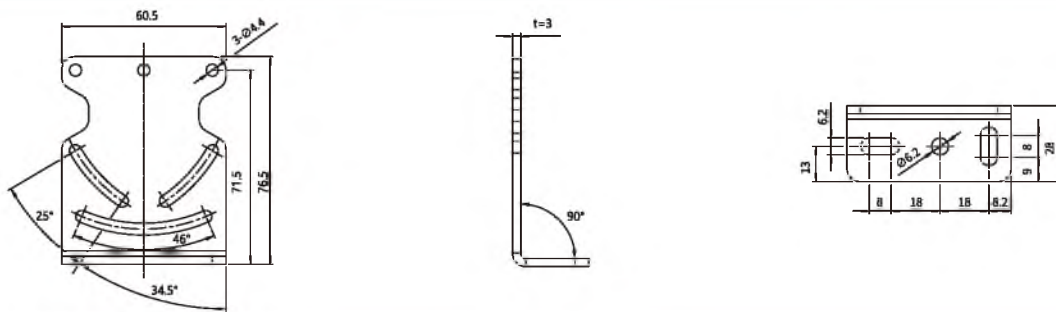

ZJP-16 (PSV Mounting rack)

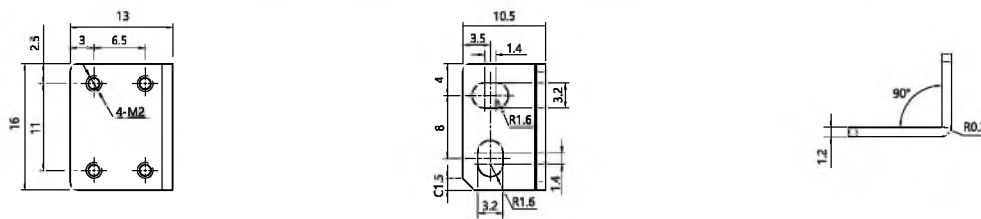

Reflector

Item Code	TD-01	TD-01-3	TD-02
Dimensions			
Item Code	TD-03	TD-04	TD-05
Dimensions			<p>Applicable models*: PTL</p>
Item Code	STD-06	TD-08	TD-09
Dimensions			<p>Applicable models*: PR18, PR18S, PR30, PTF, PSC, PTE, PSE</p>
Item Code	TD-09A	TD-10	
Dimensions	<p>Applicable models*: PSG</p>		
Item Code	TD-11	TD-12	
Dimensions			

* Refers to the standard reflector of polarized reflection series

Inductive/Capacitive sensors wiring diagram

DC 2 Wires

	Cable type	M8 Connector	M12 Connector	Terminal connect
NO				
NC				

DC 3 Wires

	Cable type	M8 Connector	M12 Connector	Terminal connect
NPN NO				
NPN NC				
PNP NO				
PNP NC				

DC 4 Wires

	Cable type	M12 Connector	Terminal connect
NPN NO+NC			
PNP NO+NC			

AC 2 Wires

	Cable type	M12 Connector	Terminal connect
SCR NO			
SCR NC			

AC/DC 2 Wires

	Cable type	M12 Connector	Terminal connect
NO			
NC			
NO/NC			

NAMUR

	Cable type	M8 Connector	M12 Connector	Terminal connect

Analog output

	Cable type	M12 Connector	Terminal connect
3 Wires Voltage output			
3 Wires Current output			
4 Wires Voltage/current output			

Connector

	M8 Connector	M12 Connector	M8 Connector

Photoelectric sensors wiring diagram

Emitter

	Cable type	M8 Connector	M12 Connector	Terminal connect
DC				
AC/DC				

DC 3 Wires

	Cable type	M8 Connector	M12 Connector	Terminal connect
NPN NO				
NPN NC				
PNP NO				
PNP NC				

DC 4 Wires

	Cable type	M12 Connector	Terminal connect
NPN NO+NC			
PNP NO+NC			
Push-pull			
RS485			
UART/IIC			

DC 4 Wires

Cable type			
Analog 4...20mA			

DC 5 Wires

Cable type			
RS485			

AC 2 Wires

	Cable type	M12 Connector	Terminal connect
SCR NO			
SCR NC			

AC/DC Wires

	Cable type	Terminal connect
Relay		

NPN

	Cable type	M12 Connector
NO/NC Optional		





PNP

	Cable type	M12 Connector
NO/NC Optional		

NPN+PNP

	Cable type	M12 Connector

Connector

	M8 Connector	M12 Connector	M8 Connector	M12 Connector
				

Алматы (727)345-47-04
 Ангарск (3955)60-70-56
 Архангельск (8182)63-90-72
 Астрахань (8512)99-46-04
 Барнаул (3852)73-04-60
 Белгород (4722)40-23-64
 Благовещенск (4162)22-76-07
 Брянск (4832)59-03-52
 Владивосток (423)249-28-31
 Владикавказ (8672)28-90-48
 Владимир (4922)49-43-18
 Волгоград (844)278-03-48
 Вологда (8172)26-41-59
 Воронеж (473)204-51-73
 Екатеринбург (343)384-55-89

Иваново (4932)77-34-06
 Ижевск (3412)26-03-58
 Иркутск (395)279-98-46
 Казань (843)206-01-48
 Калининград (4012)72-03-81
 Калуга (4842)92-23-67
 Кемерово (3842)65-04-62
 Киров (8332)68-02-04
 Коломна (4966)23-41-49
 Кострома (4942)77-07-48
 Краснодар (861)203-40-90
 Красноярск (391)204-63-61
 Курск (4712)77-13-04
 Курган (3522)50-90-47
 Липецк (4742)52-20-81

Магнитогорск (3519)55-03-13
 Москва (495)268-04-70
 Мурманск (8152)59-64-93
 Набережные Челны (8552)20-53-41
 Нижний Новгород (831)429-08-12
 Новокузнецк (3843)20-46-81
 Ноябрьск (3496)41-32-12
 Новосибирск (383)227-86-73
 Омск (3812)21-46-40
 Орел (4862)44-53-42
 Оренбург (3532)37-68-04
 Пенза (8412)22-31-16
 Петрозаводск (8142)55-98-37
 Псков (8112)59-10-37
 Пермь (342)205-81-47

Ростов-на-Дону (863)308-18-15
 Рязань (4912)46-61-64
 Самара (846)206-03-16
 Санкт-Петербург (812)309-46-40
 Саратов (845)249-38-78
 Севастополь (8692)22-31-93
 Саранск (8342)22-96-24
 Симферополь (3652)67-13-56
 Смоленск (4812)29-41-54
 Сочи (862)225-72-31
 Ставрополь (8652)20-65-13
 Сургут (3462)77-98-35
 Сыктывкар (8212)25-95-17
 Тамбов (4752)50-40-97
 Тверь (4822)63-31-35

Тольятти (8482)63-91-07
 Томск (3822)98-41-53
 Тула (4872)33-79-87
 Тюмень (3452)66-21-18
 Ульяновск (8422)24-23-59
 Улан-Удэ (3012)59-97-51
 Уфа (347)229-48-12
 Хабаровск (4212)92-98-04
 Чебоксары (8352)28-53-07
 Челябинск (351)202-03-61
 Череповец (8202)49-02-64
 Чита (3022)38-34-83
 Якутск (4112)23-90-97
 Ярославль (4852)69-52-93

Россия +7(495)268-04-70

Казахстан +7(727)345-47-04

Беларусь +375(257)127-884

Узбекистан +998(71)205-18-59

Киргизия +996(312)96-26-47

<https://lanbao.nt-rt.ru/> || ahj@nt-rt.ru